

Hitch, 2" Receiver Select Ford F-150

INSTALLATION INSTRUCTIONS

READ ALL WARNINGS AND INSTRUCTIONS BEFORE INSTALLATION

⚠ WARNING: Never exceed the vehicle manufacturer's recommended towing capacity.

NOTICE:

- Always use proper tools and safety equipment to ensure a safe and quality installation.
- Inspection of the trailer hitch should be performed before and after each use to ensure all mounting hardware is tight and related hitch components are secure.

⚠ WARNING: Before you begin installation, read all instructions thoroughly.

⚠ WARNING: Safety glasses should be worn at all times while installing this product.

⚠ WARNING: Failure to adhere to exact torque specifications when securing hardware during the installation process can result in damage to the product or your vehicle. This will void the hitch warranty.

LEVEL OF DIFFICULTY: Easy

Installation difficulty levels are based on time and effort required. They will vary depending on the installer's expertise. Vehicle condition could be a factor in the level of difficulty for a proper installation.

WEIGHT CARRYING CAPACITY

Gross Trailer Weight (GTW)	6,000 lb
Tongue Weight (TW)	900 lb

WEIGHT DISTRIBUTION CAPACITY

Weight Distribution (WD)	8,000 lb
WD Tongue Weight (WDTW)	800 lb

PARTS LIST

Item	Qty	Description
1	2	U-Shaped Spacer, 3/16" x 1" x 2"
2	6	Square-Hole Spacer, 3/8" x 1-1/4" x 2-1/2"
3	4	Carriage Bolt, 5/8"-11 x 3/4", Grade 8
4	4	Serrated-Flange Nut, 5/8"-11, Grade 8
5	4	Fish Wire, 5/8"
6	1	Flange Bolt, M8 -1.25 x 25 mm, CL10.9

TOOLS REQUIRED

Safety Glasses
Ratchet
Torque Wrench
Socket, 19 mm
Socket, 10 mm
Socket, 15/16"

Passenger-Side Frame Rail with existing weld nuts

Fish Wiring of all Four Bolts and Spacers Required.
Fish Wire Tool Included.

Driver-Side Frame Rail with existing weld nuts

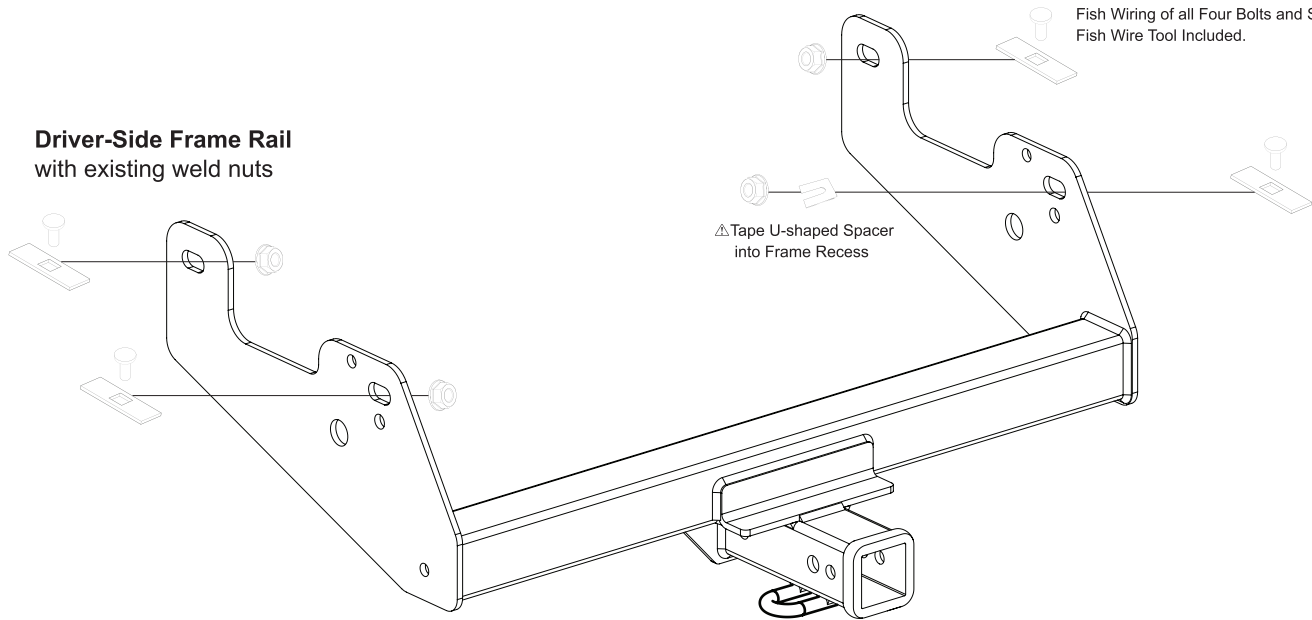

INSTALLATION:

1. Use a 10 mm socket and the grounding cable from the rear of the passenger side frame rail. Return the fastener to vehicle owner. Lower the spare tire if applicable.
2. If present, pull out the harness plug from the driver side frame rail if applicable.
3. For the rearward most holes, tape a U-shaped spacer into the recess in the frame.
4. Fish wire, (2) 5/8" carriage bolts and square-hole spacers through either an access hole or the end of the frame. Leave the hardware in the frame with the fish wires attached. Repeat on opposite side.
5. Raise the trailer hitch into the position and pull the fish wires so the carriage bolts are in their final position. Remove the fish wires carefully and loosely install the supplied 5/8" serrated flange nuts.
If applicable in Step 1, reinstall the grounding cable with the provided M8 flange bolt.
If applicable in Step 2, push the harness plug into the 1" hole on the hitch plate on the driver side.
6. Torque all M12 hardware to 86 ft-lbs.
Torque all 7/16" hardware to 70 ft-lbs.

FISH WIRE TECHNIQUE

1. Insert the coiled end of the fish wire tool through the mounting hole in the vehicle frame rail and out the access hole.
2. Thread the coiled end of the fish wire through the spacer and thread the bolt into the coil.
3. Kink the wire to keep the spacer separate from the bolt.
4. Pull the spacer and bolt through the frame and out the mounting hole.
5. Keep the fish wire secure to prevent loss of the bolt or spacer inside the frame rail.

IF YOU EXPERIENCE ANY PROBLEMS WITH YOUR TOWSMART PRODUCT, DO NOT RETURN THE UNIT TO THE RETAILER FROM WHICH IT WAS PURCHASED. INSTEAD, PLEASE CALL 1-844-295-9215 FOR ASSISTANCE WITH ANY PROBLEMS. WARRANTY INFORMATION IS AVAILABLE UPON REQUEST AND CAN BE FOUND ONLINE AT WWW.TOWSMART.COM.

©06/2023



CUSTOM

A Winston Products Company
TOWSMART.COM
WINSTON PRODUCTS, LLC.
30339 Diamond Parkway
Cleveland, OH 44139