

## Hitch, 2" Receiver, Dodge Durango Excluding SRT, Jeep Grand Cherokee Excluding SRT, SRT8, Trackhawk

### INSTALLATION INSTRUCTIONS

**READ ALL WARNINGS AND INSTRUCTIONS BEFORE INSTALLATION**

**⚠️WARNING:** Never exceed the vehicle manufacturer's recommended towing capacity.

**NOTICE:**

- Always use proper tools and safety equipment to ensure a safe and quality installation.
- Inspection of the trailer hitch should be performed before and after each use to ensure all mounting hardware is tight and related hitch components are secure.

**⚠️WARNING:** Before you begin installation, read all instructions thoroughly.

**⚠️WARNING:** Safety glasses should be worn at all times while installing this product.

**⚠️WARNING:** Failure to adhere to exact torque specifications when securing hardware during the installation process can result in damage to the product or your vehicle. This will void the hitch warranty.

**LEVEL OF DIFFICULTY:** Easy

Installation difficulty levels are based on time and effort required. They will vary depending on the installer's expertise. Vehicle condition could be a factor in the level of difficulty for a proper installation.

**WEIGHT CARRYING CAPACITY**

Gross Trailer Weight (GTW)	6,000 lb
Tongue Weight (TW)	600 lb

**WEIGHT DISTRIBUTION CAPACITY**

Weight Distribution (WD)	7,500 lb
WD Tongue Weight (WDTW)	750 lb

**PARTS LIST**

Item	Qty	Description
1		Use existing vehicle hardware

**TOOLS REQUIRED**

Safety Glasses
Torque Wrench
Socket, 13 mm
Socket, 21 mm
Utility Knife

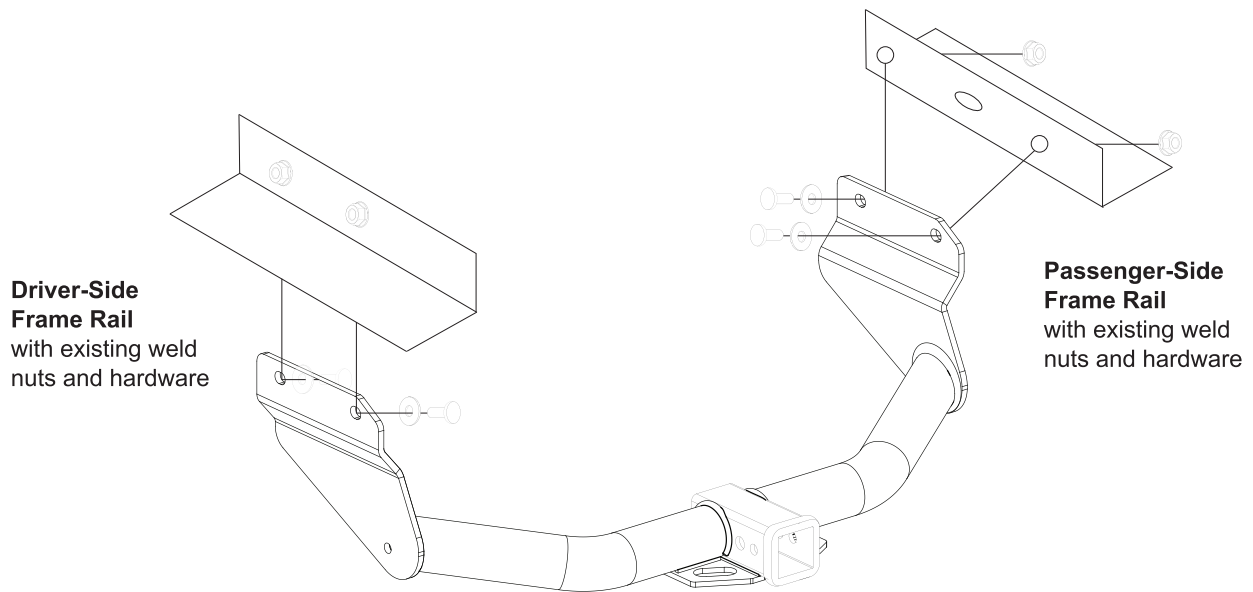

## INSTALLATION:

### DEF Tank Fastener Locations

**CAUTION:** Do not remove the filler pipe from the DEF tank. The tank should be free to rotate slightly downward on the passenger side for access to the bolts and weld nuts.

**CAUTION:** Due to the diesel exhaust fluid (DEF) tank location, it will need to be lowered to access the passenger side bolts. It is highly recommended that the tank is well supported before removing the fasteners as the tank may weigh as much as 80 lbs.

1. On diesel models, lower the DEF tank by unclipping the electrical connection on the passenger side and sliding the clips off of the rear studs securing the tank. Using a 13 mm socket, remove the two rear stud posts and the two forward hex bolts from the tank.
2. Remove the existing M14 bolts. There will be four or six bolts depending on the vehicle model. Retain four bolts for hitch installation. Return any remaining bolts to the vehicle owner.  
**Note:** If there is a factory tow loop is present you will need to remove it prior to installation. Trim excess caulk on the vehicle frame rails if it interferes with the hitch installation.
3. Raise the trailer hitch into position and reinstall four of the M14 bolts removed in Step 2. Tighten all M14 hardware to 126 ft-lbs.
4. If lowered, reinstall the DEF tank on diesel models and reconnect electrical components. Torque DEF tank studs to 21 ft-lbs and the DEF tank hex bolts to 24 ft-lbs.

### FISH WIRE TECHNIQUE

1. Insert the coiled end of the fish wire tool through the mounting hole in the vehicle frame rail and out the access hole.
2. Thread the coiled end of the fish wire through the spacer and thread the bolt into the coil.
3. Kink the wire to keep the spacer separate from the bolt.
4. Pull the spacer and bolt through the frame and out the mounting hole.
5. Keep the fish wire secure to prevent loss of the bolt or spacer inside the frame rail.

IF YOU EXPERIENCE ANY PROBLEMS WITH YOUR TOWSMART PRODUCT, DO NOT RETURN THE UNIT TO THE RETAILER FROM WHICH IT WAS PURCHASED. INSTEAD, PLEASE CALL 1-844-295-9215 FOR ASSISTANCE WITH ANY PROBLEMS. WARRANTY INFORMATION IS AVAILABLE UPON REQUEST AND CAN BE FOUND ONLINE AT TOWSMART.COM.

©06/2023



**CUSTOM**

A Winston Products Company  
TOWSMART.COM  
WINSTON PRODUCTS, LLC.  
30339 Diamond Parkway  
Cleveland, OH 44139