

Hitch, 2" Receiver, Select Honda Odyssey

INSTALLATION INSTRUCTIONS

READ ALL WARNINGS AND INSTRUCTIONS BEFORE INSTALLATION

⚠️WARNING: Never exceed the vehicle manufacturer's recommended towing capacity.

NOTICE:

- Always use proper tools and safety equipment to ensure a safe and quality installation.
- Inspection of the trailer hitch should be performed before and after each use to ensure all mounting hardware is tight and related hitch components are secure.

⚠️WARNING: Before you begin installation, read all instructions thoroughly.

⚠️WARNING: Safety glasses should be worn at all times while installing this product.

⚠️WARNING: Failure to adhere to exact torque specifications when securing hardware during the installation process can result in damage to the product or your vehicle. This will void the hitch warranty.

LEVEL OF DIFFICULTY: Easy

Installation difficulty levels are based on time and effort required. They will vary depending on the installer's expertise. Vehicle condition could be a factor in the level of difficulty for a proper installation.

WEIGHT CARRYING CAPACITY

Gross Trailer Weight (GTW)	4,500 lb
Tongue Weight (TW)	675 lb

WEIGHT DISTRIBUTION CAPACITY

Weight Distribution (WD)	5,000 lb
WD Tongue Weight (WDTW)	675 lb

PARTS LIST

Item	Qty	Description
1	4	Hex Bolt, M12-1.25 x 35 mm, CL 10.9
2	4	Conical-Toothed Washer, 1/2"
3	1	Serrated-Flange Nut, 7/16" - 14
4	1	Square-Hole Spacer, 1/4" x 7/8" x 2-1/4"
5	1	Carriage Bolt, 7/16" - 14 x 1-1/2", Grade 8
6	1	Fish wire, 7/16"

TOOLS REQUIRED

Safety Glasses
Socket Extension, 9"
Torque Wrench
Ratchet
Socket, 10 mm
Socket, 19 mm
Screwdriver
Socket, 11/16"

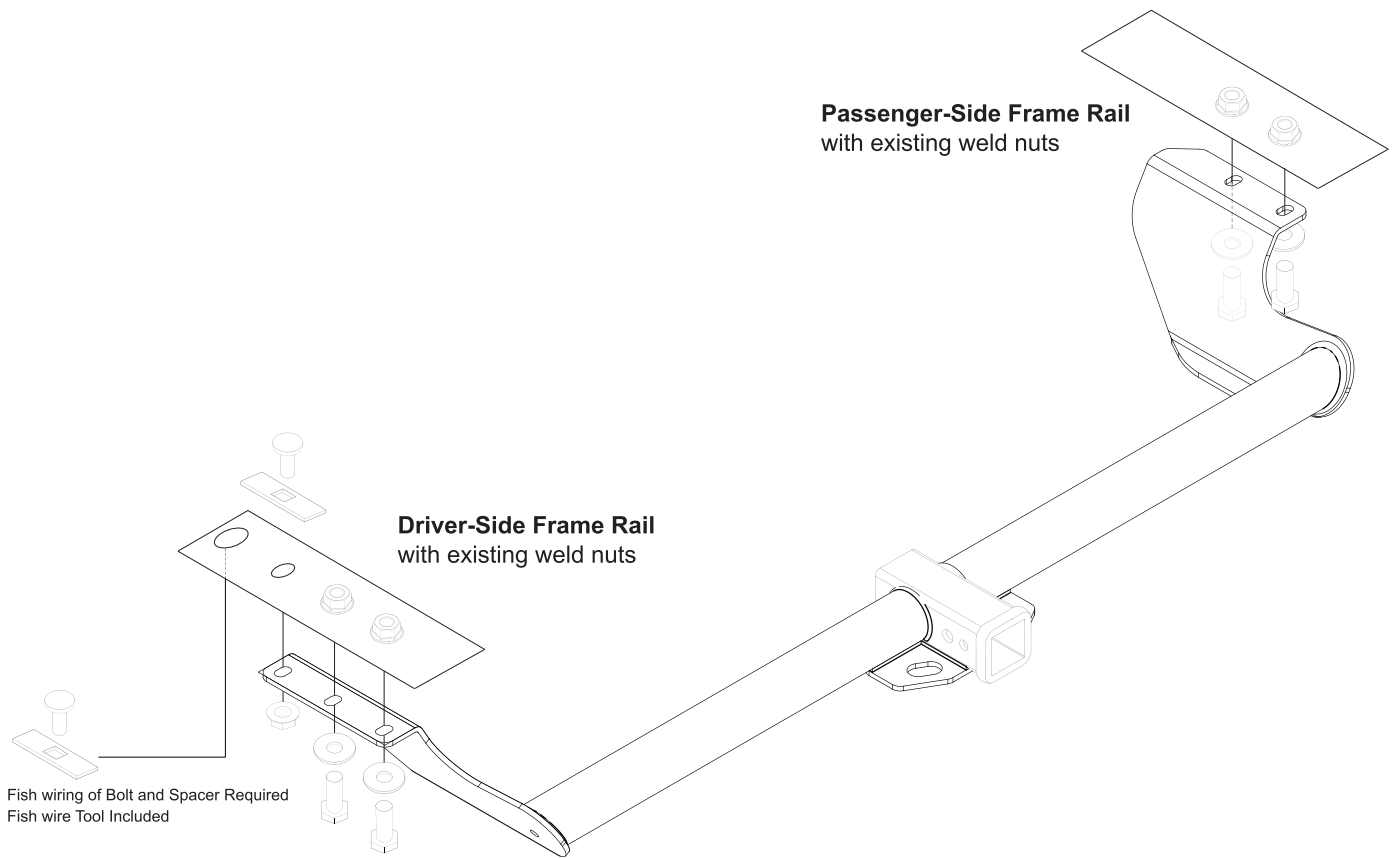

INSTALLATION:

1. Remove the five fasteners and the plastic covering from the driver-side frame rail. Return the fasteners and plastic shield to the vehicle owner.
Note: You may trim the plastic covering and reattach after hitch installation (if applicable).
2. Locate the two weld nuts near the end of each frame rail. Clean the weld nuts of debris and rust for easier hitch installation.
Weld Nut Cleaning: To remove debris from weld nuts in the frame, spray lubricant or compressed air into the hole. For heavy debris, use a wire brush. Take care not to damage threads.
3. Raise the trailer hitch into position by sliding the passenger side plate over the exhaust first. Secure hitch into position using M12-1.25 x 35 mm bolts and 1/2" conical-toothed washers.
4. On the driver-side frame rail, fish wire a 7/16-14 x 1-1/2" carriage bolt and square hole spacer through the opening and into the existing hole in the bottom of the frame rail. Secure with 7/16" serrated-flange nut.
5. Torque all M12 hardware to 86 ft-lbs.
Torque all 7/16" hardware to 70 ft-lbs.

FISH WIRE TECHNIQUE

1. Insert the coiled end of the fish wire tool through the mounting hole in the vehicle frame rail and out the access hole.
2. Thread the coiled end of the fish wire through the spacer and thread the bolt into the coil.
3. Kink the wire to keep the spacer separate from the bolt.
4. Pull the spacer and bolt through the frame and out the mounting hole.
5. Keep the fish wire secure to prevent loss of the bolt or spacer inside the frame rail.

IF YOU EXPERIENCE ANY PROBLEMS WITH YOUR TOWSMART PRODUCT, DO NOT RETURN THE UNIT TO THE RETAILER FROM WHICH IT WAS PURCHASED. INSTEAD, PLEASE CALL 1-844-295-9215 FOR ASSISTANCE WITH ANY PROBLEMS. WARRANTY INFORMATION IS AVAILABLE UPON REQUEST AND CAN BE FOUND ONLINE AT TOWSMART.COM.

©02/2024



CUSTOM

A Winston Products Company
TOWSMART.COM
WINSTON PRODUCTS, LLC.
30339 Diamond Parkway
Cleveland, OH 44139