

Hitch, 2" Receiver, Honda CR-V (EX, EX-L, LX, Touring)

INSTALLATION INSTRUCTIONS

READ ALL WARNINGS AND INSTRUCTIONS BEFORE INSTALLATION

⚠ WARNING: Never exceed the vehicle manufacturer's recommended towing capacity.

NOTICE:

- Always use proper tools and safety equipment to ensure a safe and quality installation.
- Inspection of the trailer hitch should be performed before and after each use to ensure all mounting hardware is tight and related hitch components are secure.

⚠ WARNING: Before you begin installation, read all instructions thoroughly.

⚠ WARNING: Safety glasses should be worn at all times while installing this product.

⚠ WARNING: Failure to adhere to exact torque specifications when securing hardware during the installation process can result in damage to the product or your vehicle. This will void the hitch warranty.

LEVEL OF DIFFICULTY: Easy

Installation difficulty levels are based on time and effort required. They will vary depending on the installer's expertise. Vehicle condition could be a factor in the level of difficulty for a proper installation.

WEIGHT CARRYING CAPACITY

Gross Trailer Weight (GTW)	4,000 lb
Tongue Weight (TW)	600 lb

WEIGHT DISTRIBUTION CAPACITY

Weight Distribution (WD)	4,000 lb
WD Tongue Weight (WDTW)	600 lb

PARTS LIST

Item	Qty	Description
1	4	Carr. Bolt 7/16 - 14 X 1 1/4 GR5
2	4	Spacer 3/16 x 1 x 2
3	4	Conical washer 7/16
4	4	Hex Nut 7/16 - 14 GR2
5	1	Carr. Bolt 1/2 - 13 X 2 GR5
6	1	Spacer 1/4 x 1 x 3
7	1	Lock washer 1/2
8	1	Hex Nut 1/2 - 13 GR5
9	4	Fish wire 7/16

TOOLS REQUIRED

Safety Glasses
10mm Socket
11/16 Socket
3/4 Socket
6 Socket Extension
Ratchet
Torque Wrench
Flat Head Screwdriver

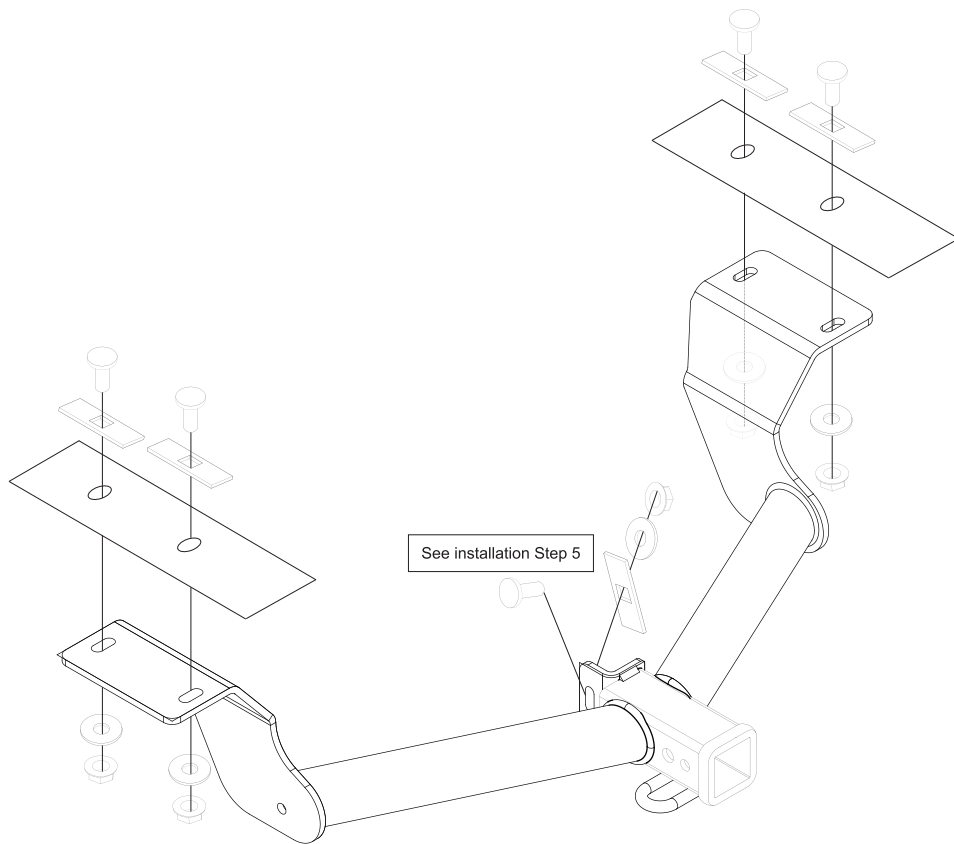

INSTALLATION:

1. Remove the rubber isolators from the exhaust at the rear of the vehicle on both sides. It may be necessary to remove the isolator forward of the rear axle as well for added clearance.
2. Remove center splash guard: Using 10mm socket remove nuts from center splash guard. Using flat head screwdriver, remove rivets. For 2023 and newer
3. Using the fish wire install items 1 and 2 as shown through the large access hole at the end of the vehicle frame. Repeat for both sides.
4. Raise hitch into position, over the mufflers. Feed the end of the fish wires through the attachment holes in the hitch while keeping hold of the fish wired fasteners. Loosely install items 3 and 4 to hold the hitch in place.
5. Install item 5 through the bracket at the back of the hitch receiver and through the tow hook, then loosely install items 6,7 & 8 onto item 5 as shown.
6. Tighten all 7/16 fasteners with torque wrench to 50 ft-lbs (68 N*M) and 1/2 fasteners to ft-lbs (102 N*M).
7. Raise the exhaust back into position and reinstall all isolators removed in step 1.

FISH WIRE TECHNIQUE

1. Insert the coiled end of the fish wire tool through the mounting hole in the vehicle frame rail and out the access hole.
2. Thread the coiled end of the fish wire through the spacer and thread the bolt into the coil.
3. Kink the wire to keep the spacer separate from the bolt.
4. Pull the spacer and bolt through the frame and out the mounting hole.
5. Keep the fish wire secure to prevent loss of the bolt or spacer inside the frame rail.

IF YOU EXPERIENCE ANY PROBLEMS WITH YOUR TOWSMART PRODUCT, DO NOT RETURN THE UNIT TO THE RETAILER FROM WHICH IT WAS PURCHASED. INSTEAD, PLEASE CALL 1-844-295-9215 FOR ASSISTANCE WITH ANY PROBLEMS. WARRANTY INFORMATION IS AVAILABLE UPON REQUEST AND CAN BE FOUND ONLINE AT TOWSMART.COM.

©03/2024



CUSTOM

A Winston Products Company
TOWSMART.COM
WINSTON PRODUCTS, LLC.
30339 Diamond Parkway
Cleveland, OH 44139