

Hitch, 2" Receiver, Ford Escape, Mazda Tribute, Mercury Mariner

INSTALLATION INSTRUCTIONS

READ ALL WARNINGS AND INSTRUCTIONS BEFORE INSTALLATION

⚠️ WARNING: Never exceed the vehicle manufacturer's recommended towing capacity.

NOTICE:

- Always use proper tools and safety equipment to ensure a safe and quality installation.
- Inspection of the trailer hitch should be performed before and after each use to ensure all mounting hardware is tight and related hitch components are secure.

⚠️ WARNING: Before you begin installation, read all instructions thoroughly.

⚠️ WARNING: Safety glasses should be worn at all times while installing this product.

⚠️ WARNING: Failure to adhere to exact torque specifications when securing hardware during the installation process can result in damage to the product or your vehicle. This will void the hitch warranty.

LEVEL OF DIFFICULTY: Easy

Installation difficulty levels are based on time and effort required. They will vary depending on the installer's expertise. Vehicle condition could be a factor in the level of difficulty for a proper installation.

WEIGHT CARRYING CAPACITY

Gross Trailer Weight (GTW)	4,500 lb
Tongue Weight (TW)	675 lb

WEIGHT DISTRIBUTION CAPACITY

Weight Distribution (WD)	5,250 lb
WD Tongue Weight (WDTW)	675 lb

PARTS LIST

Item	Qty	Description
1	6	Carriage Bolt, 7/16-14 x 1.75"
2	6	Spacer Block
3	6	Conical Lock Washer 7/16"
4	6	Hex Nut, 7/16-14
5	4	Bolt, M12 x 1.75 x 45mm CL10.9
6	4	Conical Lock Washer, 5/8"
7	4	Fish Wire

TOOLS REQUIRED

Ratchet
Torque Wrench
11/16" Socket
19mm Socket
6 "Socket Extension
22mm Socket
Safety Glasses

PARTS LIST

Item	Qty	Description
1	6	Carriage Bolt, 7/16-14 x 1.75"
2	6	Spacer Block
3	6	Conical Lock Washer 7/16"
4	6	Hex Nut, 7/16-14
5	4	Bolt, M12 x 1.75 x 45mm CL10.9
6	4	Conical Lock Washer, 5/8"
7	4	Fish Wire

Installation for Vehicles without existing OEM Class II Hitch.

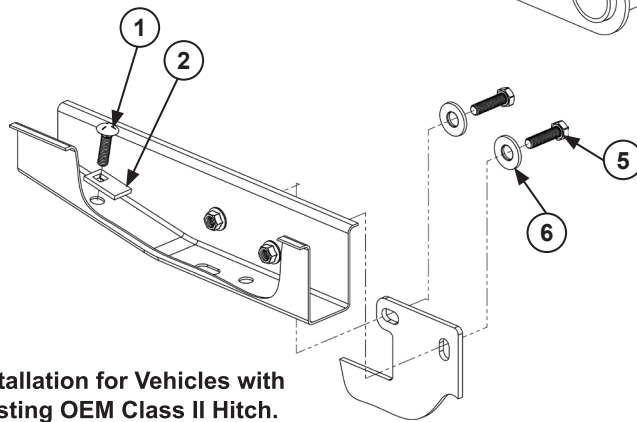
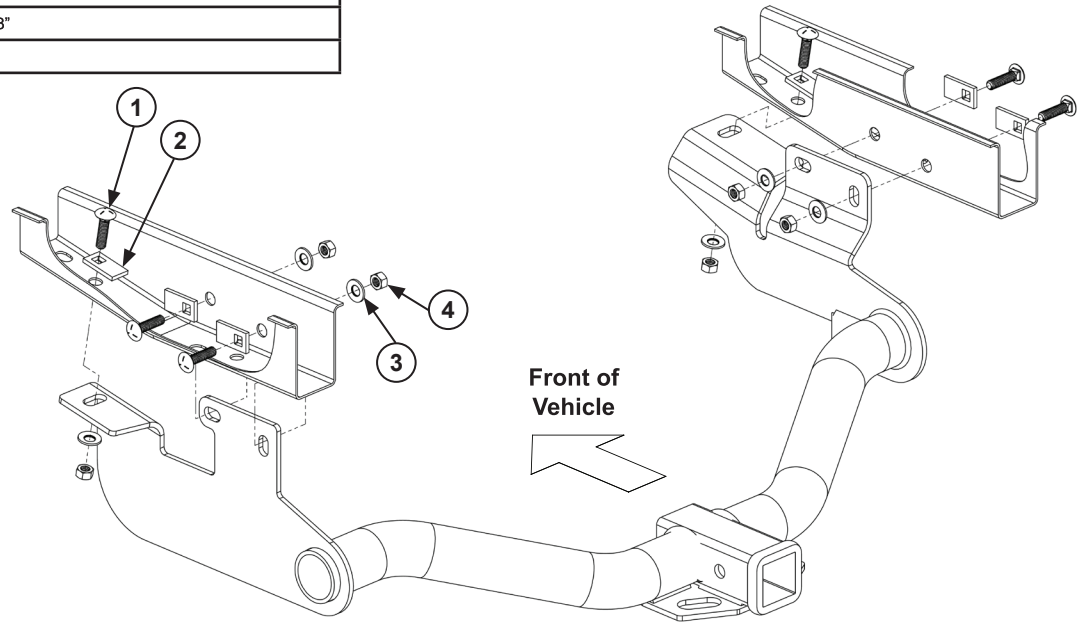

Installation for Vehicles with existing OEM Class II Hitch.

Fish Wire Technique

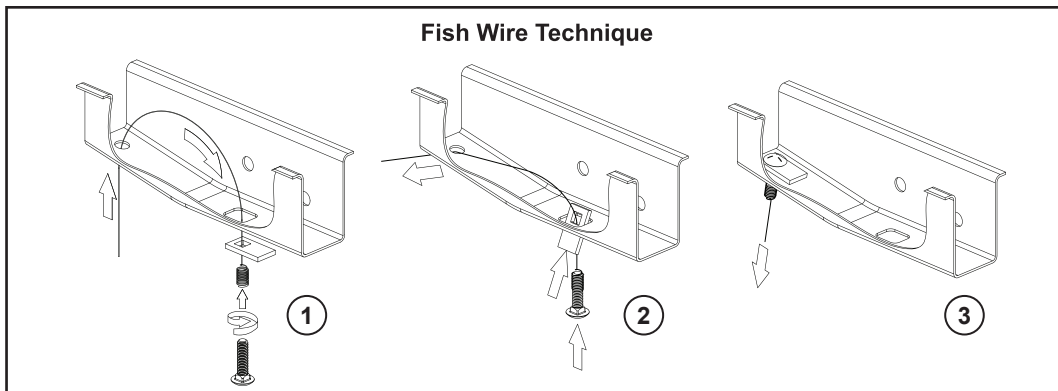

IF YOU EXPERIENCE ANY PROBLEMS WITH YOUR TOWSMART PRODUCT, DO NOT RETURN THE UNIT TO THE RETAILER FROM WHICH IT WAS PURCHASED. INSTEAD, PLEASE CALL 1-844-295-9215 FOR ASSISTANCE WITH ANY PROBLEMS. WARRANTY INFORMATION IS AVAILABLE UPON REQUEST AND CAN BE FOUND ONLINE AT TOWSMART.COM.

©05/2024



CUSTOM

A Winston Products Company
 TOWSMART.COM
 WINSTON PRODUCTS, LLC.
 30339 Diamond Parkway
 Cleveland, OH 44139

INSTALLATION:

For installation on vehicles with OEM class 2 integrated hitch bumper.

See second set of installation instructions for vehicles without an OEM hitch.

1. Remove existing bolts from inside of frame rail and provide to owner.
2. Relocate electrical bracket using the outside driver's side mounting hole only instead of the current left and center mounting holes.
Mount using the hole on the right side of the bracket.
3. Lift hitch into position and install conical washers and hex bolts using existing vehicle weld nuts.
4. Using the fish wire, feed the carriage bolts and block spacers through the access hole in the end of the frame and pull down into place
5. Affix conical toothed washer and hex nuts.

NEVER USE BOTH THE NEWLY INSTALLED HITCH AND THE OEM HITCH AT THE SAME TIME.

Tighten M12 CL10.9 Fasters with a torque wrench to 75 ft-lbs.

Tighten 7/16 – 14GR5 Fasters with a torque wrench to 50 ft-lbs.

For installation on vehicles without OEM class 2 integrated hitch bumper.

1. Using the provided fish wire, feed the 7/16-14 carriage bolt and block into the forward hole, using the access hole on the passenger's frame rail.
2. Using the provided fish wire, feed 7/16-14 carriage bolt and block in the forward driver's side frame rail using the access hole.
3. Lift hitch into position and install conical washers hex nuts. Finger tighten fasteners in this step.
4. Using the fish wire, feed the remaining carriage bolts and block spacers through the frame rails on each side (2 on each side).
5. Tighten all nuts based on the recommended torque rating below.
Tighten 7/16 – 14GR5 fasters with a torque wrench to 50 ft-lbs.

FISH WIRE TECHNIQUE

1. Insert the coiled end of the fish wire tool through the mounting hole in the vehicle frame rail and out the access hole.
2. Thread the coiled end of the fish wire through the spacer and thread the bolt into the coil.
3. Kink the wire to keep the spacer separate from the bolt.
4. Pull the spacer and bolt through the frame and out the mounting hole.
5. Keep the fish wire secure to prevent loss of the bolt or spacer inside the frame rail.

IF YOU EXPERIENCE ANY PROBLEMS WITH YOUR TOWSMART PRODUCT, DO NOT RETURN THE UNIT TO THE RETAILER FROM WHICH IT WAS PURCHASED. INSTEAD, PLEASE CALL 1-844-295-9215 FOR ASSISTANCE WITH ANY PROBLEMS. WARRANTY INFORMATION IS AVAILABLE UPON REQUEST AND CAN BE FOUND ONLINE AT TOWSMART.COM.

©05/2024



CUSTOM

A Winston Products Company
TOWSMART.COM
WINSTON PRODUCTS, LLC.
30339 Diamond Parkway
Cleveland, OH 44139