

## Hitch, 2" Receiver, AUDI Q5

### INSTALLATION INSTRUCTIONS

#### READ ALL WARNINGS AND INSTRUCTIONS BEFORE INSTALLATION

**⚠ WARNING:** Never exceed the vehicle manufacturer's recommended towing capacity.

#### NOTICE:

- Always use proper tools and safety equipment to ensure a safe and quality installation.
- Inspection of the trailer hitch should be performed before and after each use to ensure all mounting hardware is tight and related hitch components are secure.

**⚠ WARNING:** Before you begin installation, read all instructions thoroughly.

**⚠ WARNING:** Safety glasses should be worn at all times while installing this product.

**⚠ WARNING:** Failure to adhere to exact torque specifications when securing hardware during the installation process can result in damage to the product or your vehicle. This will void the hitch warranty.

#### LEVEL OF DIFFICULTY: Easy

Installation difficulty levels are based on time and effort required. They will vary depending on the installer's expertise. Vehicle condition could be a factor in the level of difficulty for a proper installation.

#### WEIGHT CARRYING CAPACITY

|                            |          |
|----------------------------|----------|
| Gross Trailer Weight (GTW) | 5,000 lb |
| Tongue Weight (TW)         | 750 lb   |

#### WEIGHT DISTRIBUTION CAPACITY

|                          |     |
|--------------------------|-----|
| Weight Distribution (WD) | N/A |
| WD Tongue Weight (WDTW)  | N/A |

#### PARTS LIST

| Item | Qty | Description                    |
|------|-----|--------------------------------|
| 1    |     | Uses Existing Vehicle Hardware |

#### TOOLS REQUIRED

|                            |
|----------------------------|
| Safety Glasses             |
| Ratchet                    |
| 6 Ratchet Extension        |
| Torque Wrench              |
| 10mm/16mm Socket           |
| T20/T25 Torxbit Sockets    |
| Plastic Panel Removal Tool |
| Masking Tape               |
| Aviation Sheers            |

## PARTS LIST

| Item | Qty | Description                    |
|------|-----|--------------------------------|
| 1    |     | Uses Existing Vehicle Hardware |

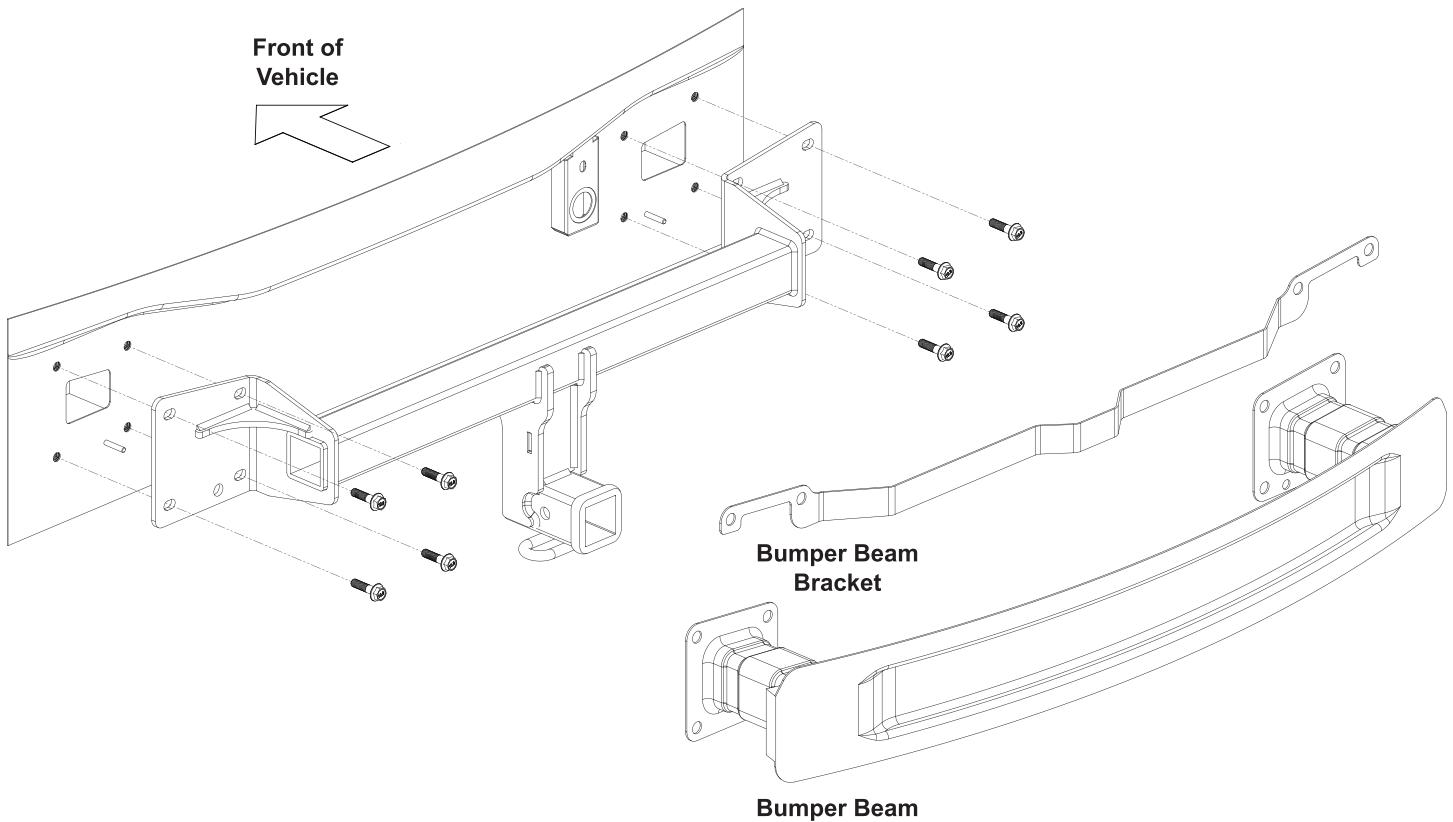

## INSTALLATION:

**NOTICE:** During screw, nut and bolt removal, place hardware and label according to the step they were removed.

This will help eliminate hardware confusion during the re-installation process.

1. Remove (4) screws from the bottom of the bumper fascia and (2) screws from the bottom inside of the wheel well, and (1) screw in each wheel well, using T25 torxbit socket.
2. Pull away wheel well lining to expose (6) screws, (3) on each side, and remove using T25 torxbit socket.
3. Pull away wheel well trim to reveal screw and remove using T25 torxbit socket. Then, open lift gate to reveal (2) screws. Remove using T20 torxbit socket.
4. Remove trunk floor and use pry tool to remove trunk edge trim starting from either side.
5. On the inside of the trunk locate (2) rubber plugs each of which will be present on each side, and use the pry tool to remove plugs to access (2) nuts, (1) on each side, and remove using 10mm socket.
6. Remove access panel on either side of trunk and locate (2) nuts, (1) on either side, and remove using your 10mm socket.
7. Carefully remove bumper fascia starting from each side while working towards the rear of car. Place in a safe location. Find (8) M10 bolts on the bumper beam and remove using a 16mm socket. Remove bumper beam and bracket as shown.
8. Raise hitch into position and secure with hardware removed from Step 7. Torque M10 hardware to 45 ft-lbs.
9. Temporarily unhook the kick sensor wire from the clips. Using masking tape, mark out the 3.25 section in-between the center sensor clips and trim using aviation shears. Re-install bumper fascia to vehicle following Step 7 in reverse order and reattach the kick sensor wire. Follow steps 1-6 in reverse order to complete installation.

IF YOU EXPERIENCE ANY PROBLEMS WITH YOUR TOWSMART PRODUCT, DO NOT RETURN THE UNIT TO THE RETAILER FROM WHICH IT WAS PURCHASED. INSTEAD, PLEASE CALL 1-844-295-9215 FOR ASSISTANCE WITH ANY PROBLEMS. WARRANTY INFORMATION IS AVAILABLE UPON REQUEST AND CAN BE FOUND ONLINE AT TOWSMART.COM.

©05/2024



**CUSTOM**

A Winston Products Company  
TOWSMART.COM  
WINSTON PRODUCTS, LLC.  
30339 Diamond Parkway  
Cleveland, OH 44139