

Hitch, 2" Receiver, Ford Transit

INSTALLATION INSTRUCTIONS

READ ALL WARNINGS AND INSTRUCTIONS BEFORE INSTALLATION

⚠ WARNING: Never exceed the vehicle manufacturer's recommended towing capacity.

NOTICE:

- Always use proper tools and safety equipment to ensure a safe and quality installation.
- Inspection of the trailer hitch should be performed before and after each use to ensure all mounting hardware is tight and related hitch components are secure.

⚠ WARNING: Before you begin installation, read all instructions thoroughly.

⚠ WARNING: Safety glasses should be worn at all times while installing this product.

⚠ WARNING: Failure to adhere to exact torque specifications when securing hardware during the installation process can result in damage to the product or your vehicle. This will void the hitch warranty.

LEVEL OF DIFFICULTY: Easy

Installation difficulty levels are based on time and effort required. They will vary depending on the installer's expertise. Vehicle condition could be a factor in the level of difficulty for a proper installation.

WEIGHT CARRYING CAPACITY

Gross Trailer Weight (GTW)	6,000 lb
Tongue Weight (TW)	900 lb

WEIGHT DISTRIBUTION CAPACITY

Weight Distribution (WD)	8,000 lb
WD Tongue Weight (WDTW)	900 lb

PARTS LIST

Item	Qty	Description
1	4	Hex Flange Bolt, M12x1.75,30,CL10.9,CZ
2	2	Carriage Bolt, 1/2-13 UNC,1-1/2,GRD8,YZ
3	2	.250 x 1.00 x 3.00" Hole Spacer
4	2	Nut Flange,1/2-13 UNC,GRD8,YZ
5	2	Fish Wire

TOOLS REQUIRED

Safety Glasses
Ratchet
Ratchet Extension 3"
Torque Wrench & Adapter
17mm 3/4 Socket

PARTS LIST

Item	Qty	Description
1	4	Hex Flange Bolt, M12x1.75,30,CL10.9,CZ
2	2	Carriage Bolt, 1/2-13 UNC, 1-1/2,GRD8,YZ
3	2	.250 x 1.00 x 3.00" Hole Spacer
4	2	Nut Flange, 1/2-13 UNC,GRD8,YZ
5	2	Fish wire

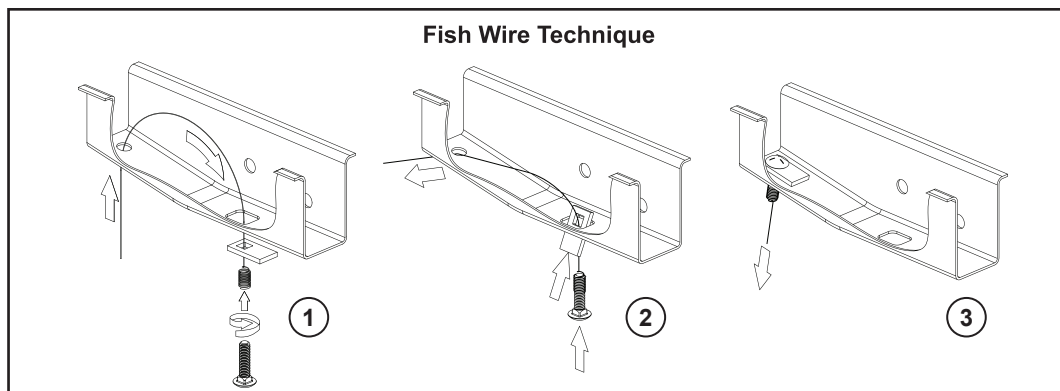
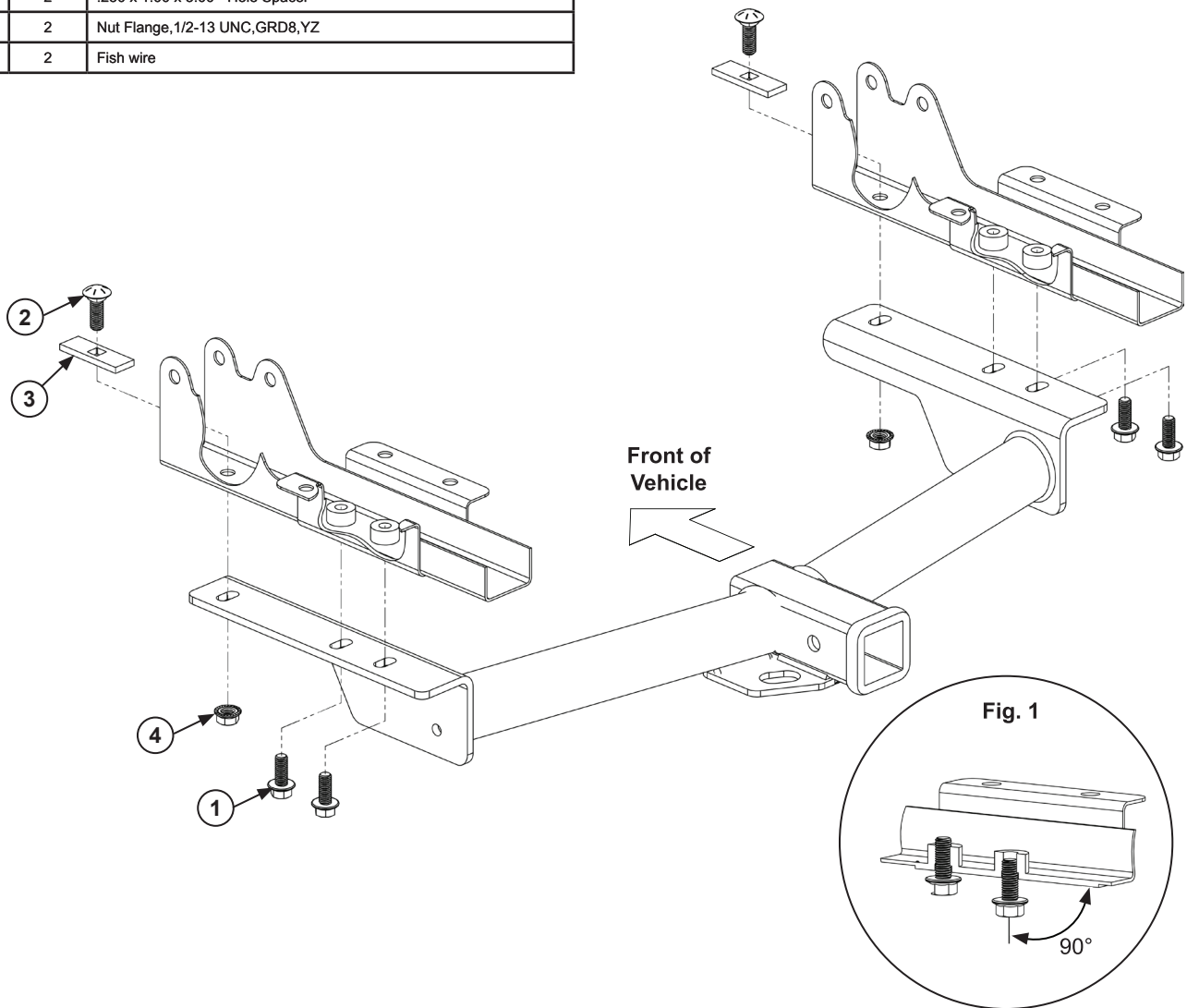

IF YOU EXPERIENCE ANY PROBLEMS WITH YOUR TOWSMART PRODUCT, DO NOT RETURN THE UNIT TO THE RETAILER FROM WHICH IT WAS PURCHASED. INSTEAD, PLEASE CALL 1-844-295-9215 FOR ASSISTANCE WITH ANY PROBLEMS. WARRANTY INFORMATION IS AVAILABLE UPON REQUEST AND CAN BE FOUND ONLINE AT TOWSMART.COM.

©05/2024



CUSTOM

A Winston Products Company
TOWSMART.COM
WINSTON PRODUCTS, LLC.
30339 Diamond Parkway
Cleveland, OH 44139

INSTALLATION:

1. Start the M12 x 1.75 self-tapping, hex-head bolts into the four frame rail locations as shown, being careful to keep them perpendicular as shown in Fig. 1. Thread bolts at least half-way and then remove for re-installation in Step 2.
2. After raising the hitch into the correct position, thread all four self-tapping into their locations shown in the main illustration and loosely secure them to hold the hitch in position.
3. Fish wire one 1/2" bolt and spacer into each frame rail on the driver and passenger side of the vehicle, while carefully securing using 1/2" hex nuts provided. Be careful not to push the bolt and spacer back into the frame rails.
4. Torque M12 bolts to 90 ft-lbs. Torque 1/2" hex nuts to 110 ft-lbs.

FISH WIRE TECHNIQUE

1. Insert the coiled end of the fish wire tool through the mounting hole in the vehicle frame rail and out the access hole.
2. Thread the coiled end of the fish wire through the spacer and thread the bolt into the coil.
3. Kink the wire to keep the spacer separate from the bolt.
4. Pull the spacer and bolt through the frame and out the mounting hole.
5. Keep the fish wire secure to prevent loss of the bolt or spacer inside the frame rail.

IF YOU EXPERIENCE ANY PROBLEMS WITH YOUR TOWSMART PRODUCT, DO NOT RETURN THE UNIT TO THE RETAILER FROM WHICH IT WAS PURCHASED. INSTEAD, PLEASE CALL 1-844-295-9215 FOR ASSISTANCE WITH ANY PROBLEMS. WARRANTY INFORMATION IS AVAILABLE UPON REQUEST AND CAN BE FOUND ONLINE AT TOWSMART.COM.

©05/2024



CUSTOM

A Winston Products Company
TOWSMART.COM
WINSTON PRODUCTS, LLC.
30339 Diamond Parkway
Cleveland, OH 44139