

## Hitch, 2" Receiver, Jeep Cherokee

### INSTALLATION INSTRUCTIONS

#### READ ALL WARNINGS AND INSTRUCTIONS BEFORE INSTALLATION

**⚠ WARNING:** Never exceed the vehicle manufacturer's recommended towing capacity.

#### NOTICE:

- Always use proper tools and safety equipment to ensure a safe and quality installation.
- Inspection of the trailer hitch should be performed before and after each use to ensure all mounting hardware is tight and related hitch components are secure.

**⚠ WARNING:** Before you begin installation, read all instructions thoroughly.

**⚠ WARNING:** Safety glasses should be worn at all times while installing this product.

**⚠ WARNING:** Failure to adhere to exact torque specifications when securing hardware during the installation process can result in damage to the product or your vehicle. This will void the hitch warranty.

#### LEVEL OF DIFFICULTY: Easy

Installation difficulty levels are based on time and effort required. They will vary depending on the installer's expertise. Vehicle condition could be a factor in the level of difficulty for a proper installation.

#### WEIGHT CARRYING CAPACITY

Gross Trailer Weight (GTW)	5,000 lb
Tongue Weight (TW)	500 lb

#### WEIGHT DISTRIBUTION CAPACITY

Weight Distribution (WD)	5,000 lb
WD Tongue Weight (WDTW)	500 lb

#### PARTS LIST

Item	Qty	Description
1	4	½-13 UNC X 1-1/2" Carriage Bolt, Grd8
2	4	.250 X 1.00 X 3.00" Rectangular Washer
3	4	½-13 UNC Flanged Hex Nut, Grd8
4	4	½" X 20" Fish Wire
5	4	12" Cable Tie

#### TOOLS REQUIRED

Ratchet
Ratchet Extension 6"
Torque Wrench
Pliers
7mm, 8mm, 10mm, 13mm, 21mm, 17mm, ¾ Sockets
Safety Glasses

## PARTS LIST

Item	Qty	Description
1	4	½-13 UNC X 1-1/2" Carriage Bolt, Grd8
2	4	.250 X 1.00 X 3.00" Rectangular Washer
3	4	½-13 UNC Flanged Hex Nut, Grd8
4	4	½" X 20" Fish wire
5	4	12" Cable Tie

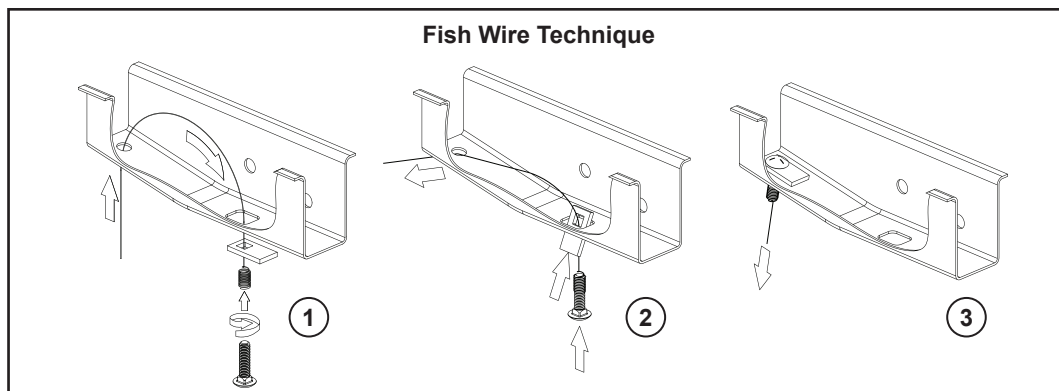
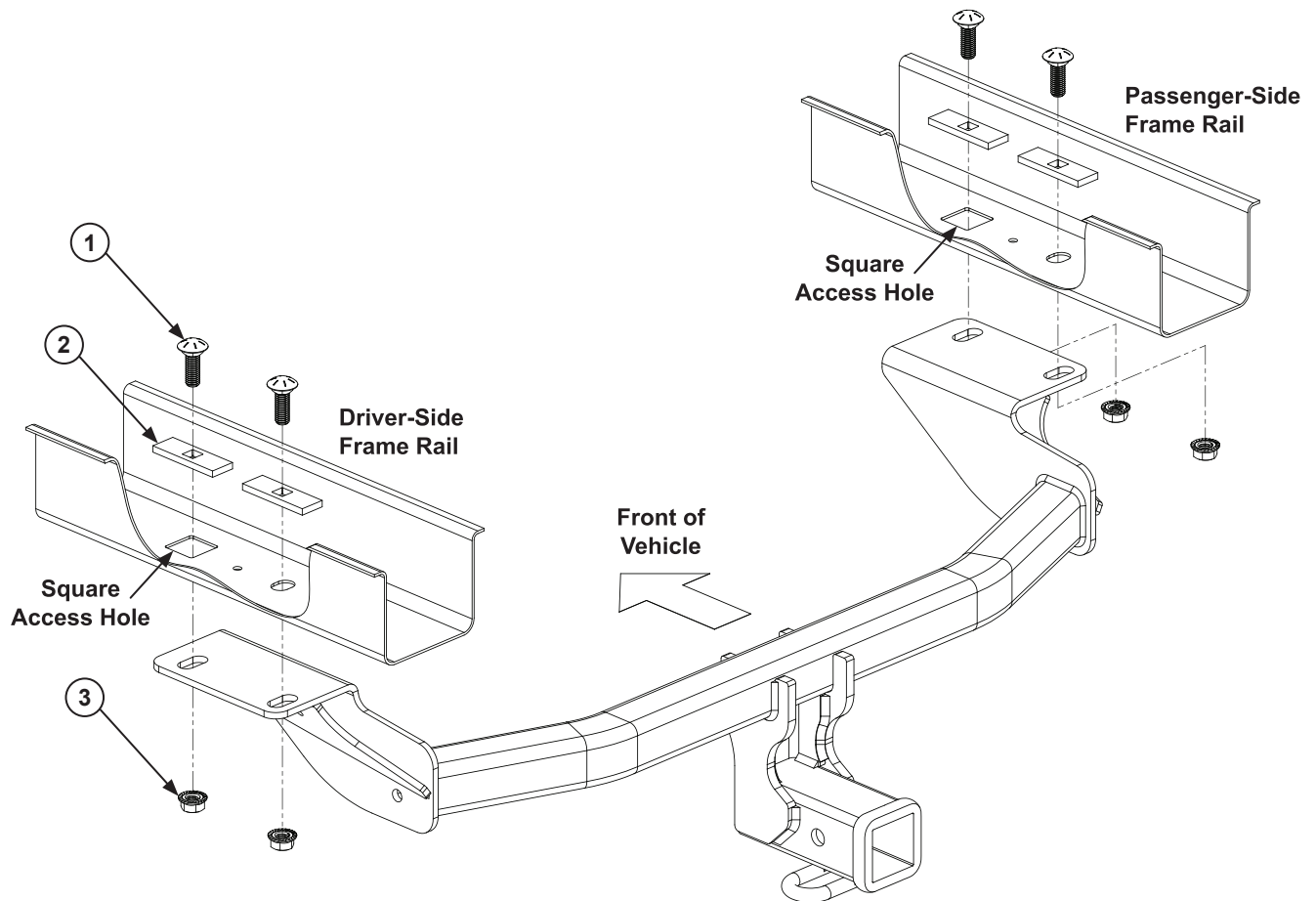

IF YOU EXPERIENCE ANY PROBLEMS WITH YOUR TOWSMART PRODUCT, DO NOT RETURN THE UNIT TO THE RETAILER FROM WHICH IT WAS PURCHASED. INSTEAD, PLEASE CALL 1-844-295-9215 FOR ASSISTANCE WITH ANY PROBLEMS. WARRANTY INFORMATION IS AVAILABLE UPON REQUEST AND CAN BE FOUND ONLINE AT TOWSMART.COM.

©05/2024



**CUSTOM**

A Winston Products Company  
TOWSMART.COM  
WINSTON PRODUCTS, LLC.  
30339 Diamond Parkway  
Cleveland, OH 44139

## INSTALLATION:

1. If present, remove integrated rear fascia exhaust outlets – use a 7mm socket to remove (3) bolts from around each exhaust outlet.
2. Use 13mm socket to remove (2) bolts that connect exhaust hanger bracket to the frame on each side. Support exhaust to prevent damage.
3. Using an 8mm socket, remove (4) lower fascia support fasteners and press down on tabs to detach plastic panel. Trailhawk models have (4) additional rivets that secure the heat shield
4. Locate center line of lower fascia and trim accordingly.
5. Remove (1) rubber square plug from each frame rail. Detach (3) vehicle wiring plastic fasteners from frame rail both sides, using a screwdriver or trim panel tool.  
**NOTICE:** On Trailhawk models remove (2) existing M14 bolts from the rear vertical and horizontal frame on each side. Keep them for reassembly.
6. Fish wire the carriage bolt and spacer through the access square hole using the pull wires for both vertical and horizontal slots, as shown. Leave pull wires attached.  
**NOTICE:** On Trailhawk models only feed vertical hardware through the forward square slot and reuse (2) M14 bolts removed in previous step each side.
7. Lift hitch into position, over the exhaust, and feed the pull wires through bracket slot. Remove pull wires and loosely secure conical washer, hex nut, lock washer (if needed) and M14 bolts (Trailhawk only) to the hitch.  
**NOTICE:** Remove the seam sealer on the side of the frame for proper fitment. Verify if the trim area is enough for the hitch. Make additional trimming if needed.
8. Tighten all ½-13 GR8 fasteners with torque wrench to 110 ft-lbs. and all M14 CL 10.9 fasteners to 148 ft-lbs.
9. Re-secure vehicle wiring to the exhaust hanger bracket.
10. Reinstall the bottom plastic panel, lower fascia, and exhaust removed previously.

## For 2019 Models Specifically:

1. Using 10mm socket, remove (4) bolts from the bottom panel. Using flat head screwdriver, remove (1) plastic clip from the side of lower fascia, both sides. Carefully unclip the tabs from the rear side of fascia and separate the lower portion by pulling rearward. Using 10mm socket, remove 4 flange nuts that attach the bottom panel to the end panel.  
**NOTICE:** On Trailhawk models, do not remove the lower fascia. After removing (4) bolts from bottom panel, pull the lower edge of fascia by hand and remove 4 flange nuts as mentioned. Remove the bottom panel and return to vehicle owner with fasteners.
2. Using 13mm socket, remove (2) bolts that connect exhaust hanger bracket to the frame rails, per side.  
**NOTICE:** Support exhaust before removing exhaust hanger brackets.
3. Using a flat head screwdriver, detach (3) vehicle wiring plastic fasteners from frame rails if present.  
**NOTICE:** On Trailhawk models remove (2) factory M14 bolts from the rear vertical and horizontal frame on each side. Keep them for reattachment.
4. Using knife, remove the seam sealer near the mounting holes for proper fitment.
5. For Trailhawk models only, locate the center of lower fascia and trim the area. For non-Trailhawk models, trim the fascia after step 7.
6. Fish Wire the carriage bolts and spacers through square access hole using the pull wires for both vertical and horizontal attachments, both sides, leaving pull wires attached.  
**NOTICE:** On Trailhawk models only feed (1) vertical hardware through forward square slot and reuse (2) M14 bolts removed in Step 7. Raise hitch into position, over the exhaust, and feed the pull wires through bracket slot. Remove pull wires and loosely install conical washers, hex nuts, lock washers (if needed), or M14 bolts (Trailhawk models only) to the hitch.
7. Tighten all ½-13 GR8 fasteners with torque wrench to 110 ft-lbs. and all M14 CL 10.9 fasteners to 148 ft-lbs.
8. Secure wiring and lower fascia: Use (2) cable ties to secure vehicle wiring to exhaust hanger bracket and (2) cable ties for lower fascia to crosstube.
9. Reinstall exhaust hanger bolts, exhaust hanger bracket, muffler, plastic clips, and lower fascia back to vehicle.

## FISH WIRE TECHNIQUE

1. Insert the coiled end of the fish wire tool through the mounting hole in the vehicle frame rail and out the access hole.
2. Thread the coiled end of the fish wire through the spacer and thread the bolt into the coil.
3. Kink the wire to keep the spacer separate from the bolt.
4. Pull the spacer and bolt through the frame and out the mounting hole.
5. Keep the fish wire secure to prevent loss of the bolt or spacer inside the frame rail.

IF YOU EXPERIENCE ANY PROBLEMS WITH YOUR TOWSMART PRODUCT, DO NOT RETURN THE UNIT TO THE RETAILER FROM WHICH IT WAS PURCHASED. INSTEAD, PLEASE CALL 1-844-295-9215 FOR ASSISTANCE WITH ANY PROBLEMS. WARRANTY INFORMATION IS AVAILABLE UPON REQUEST AND CAN BE FOUND ONLINE AT TOWSMART.COM.



**CUSTOM**

A Winston Products Company  
TOWSMART.COM  
WINSTON PRODUCTS, LLC.  
30339 Diamond Parkway  
Cleveland, OH 44139