

TOWSMART Part Number: 2063

ORIS Part Number: 200764

Instrucciones de montaje — Instruction de montage — Fitting instruction

Mercedes GLA (SUV) (H247)

12/2018 -

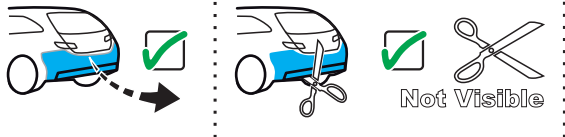

- AdBlue
- AWD
- PDC
- Hands-Free access
- AMG

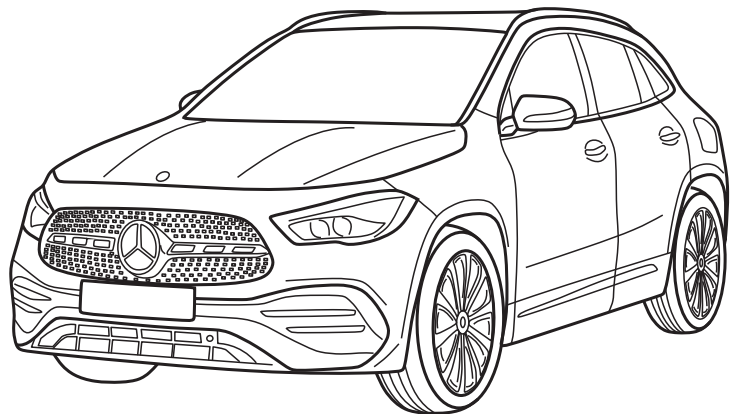

Mercedes GLB (SUV) (X247)

08/2019-

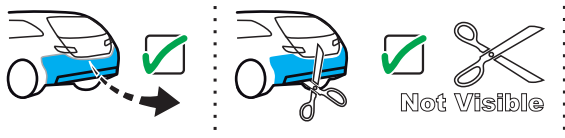

- AMG line
- AWD
- PDC
- AdBlue
- Hands-Free access
- AMG

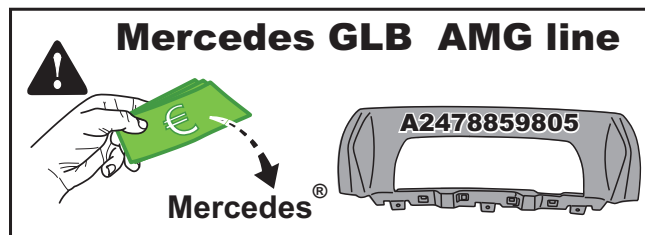
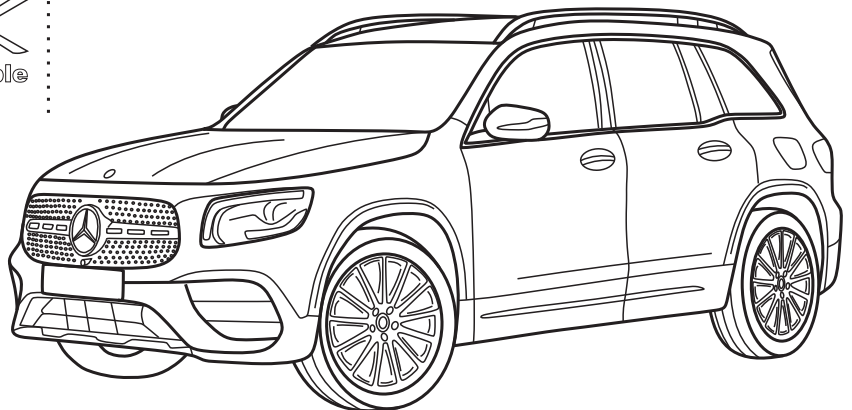

Check our webpage for the latest and a full-color copy of this fitting instruction.



THESE INSTRUCTIONS MUST BE GIVEN TO THE END USER

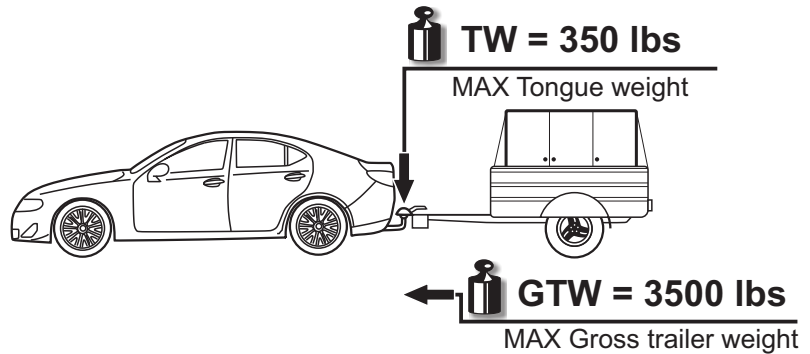
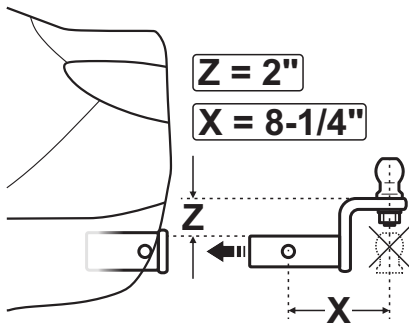

Never exceed the vehicle or the hitch manufacturer's recommended towing capacity and tongue weight.



IMPORTANT SAFETY NOTICE FOR HITCH INSTALLERS AND CUSTOMERS

Read all installation, operating and safety instructions along with all labels before installing or using this product. Failure to comply with the safety information could result in serious injury or death.



www.oris-automotive.com/en/safety/



WARNING: This product can expose you to chemicals including carbon black, which is known to the State of California to cause cancer. For more information go to www.P65Warnings.ca.gov



WARNING: Do not perform any installation or towing procedures without fully understanding the correct tools and actions for all steps. Call for support if needed.



www.oris-automotive.com/en/acps-automotive-aftermarket-worldwide/

Legend / Légende / Leyenda



US Attention
F Attention
E Atención



US Incorrect
F Incorrect
E Incorrecto



US Correct
F Correct
E Correcto



US Inspect
F Examiner
E Revise



US In both sides
F Tous les deux côtés
E En ambos lados



US Manually
F À la main
E A mano



US Only 2 persons may carry out
F Toujours s'y mettre de deux
E Operación que requiere dos personas



US Remove
F Rebuter
E Tratamiento de residuos



US Location/Position Arrow
F Flèche de Position
E Flecha de posición



US Movement Arrow
F Flèche de mouvement
E Flecha de movimiento



US Protect it against corrosion
F Protéger contre la corrosion
E Proteger contra la corrosión



US Electrical connection
F Connexion électrique
E Conexión eléctrica

Tools Required / Outils requis / Herramientas requeridas

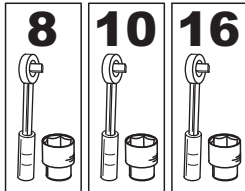

RATCHET WITH SOCKET

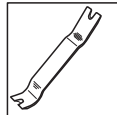

PLASTIC PRY



CUTTING TOOL



TORQUE WRENCH WITH SOCKET 10, 17

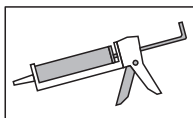

SEALANT

Safety / Sécurité / Seguridad

Should be worn at all times while installing this product.

Il doit être porté en permanence lors de l'installation de ce produit.

Debe llevarse en todo momento mientras se instala este producto.



Assembly / Assemblage / Montaje

Mounting time

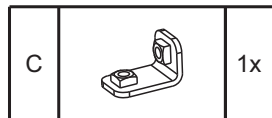
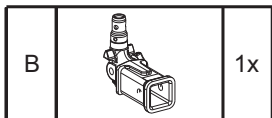
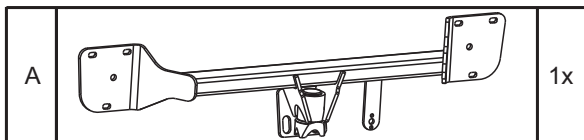
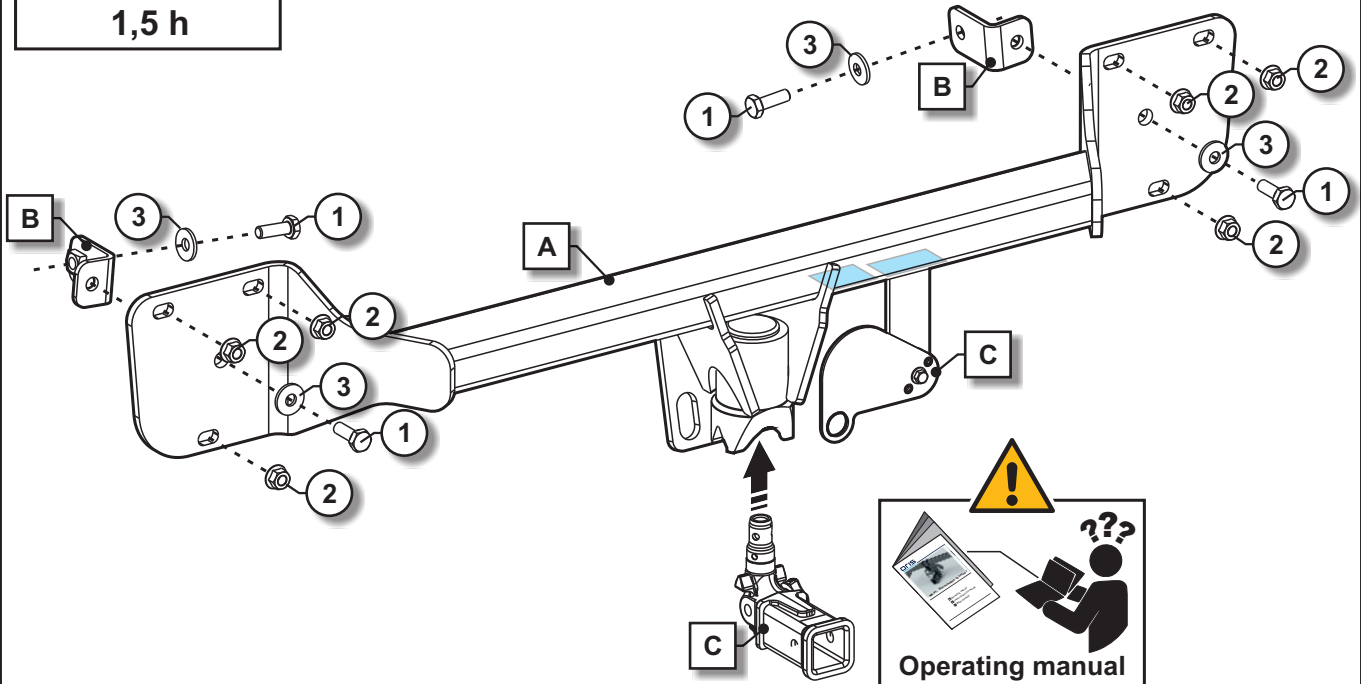
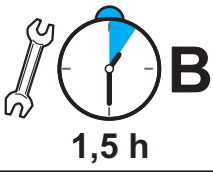

1		M10x30	10.9	4x	50 ft-lbs
2		M10	10	6x	50 ft-lbs
3		10x27x2,8		4x	

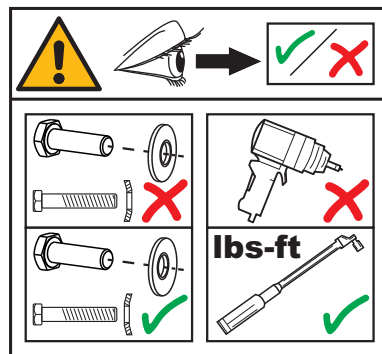

Spare Parts

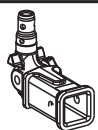

290019



290029

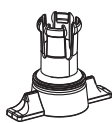

290039



290079

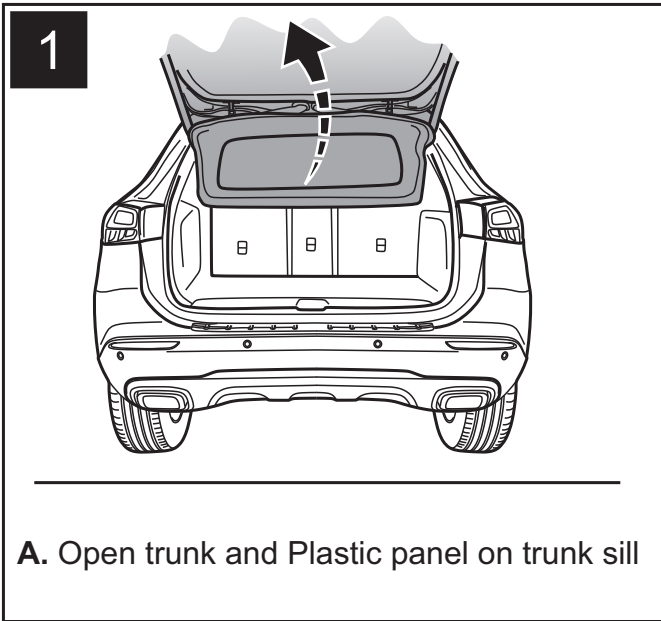

1
A. Open trunk and Plastic panel on trunk sill

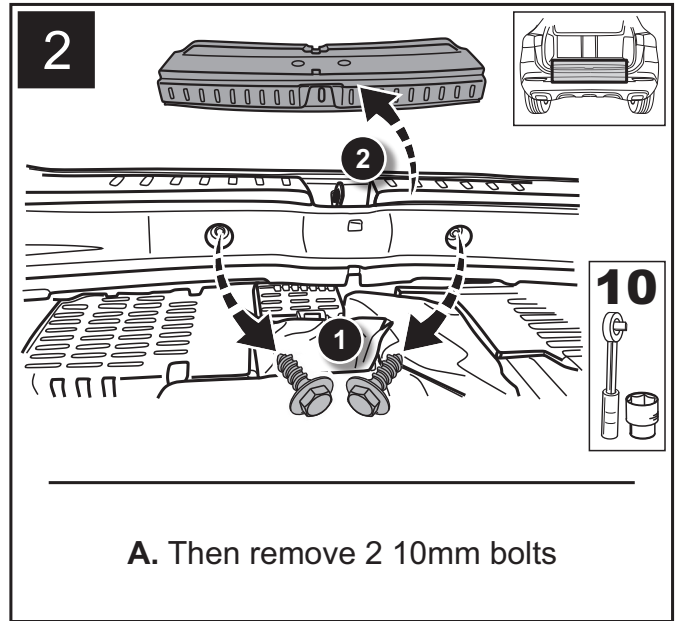

2
A. Then remove 2 10mm bolts

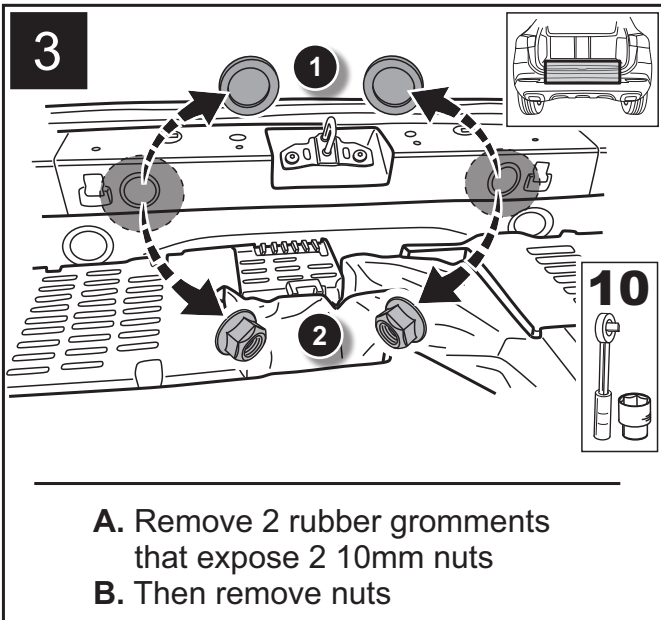

3
A. Remove 2 rubber grommets that expose 2 10mm nuts
B. Then remove nuts

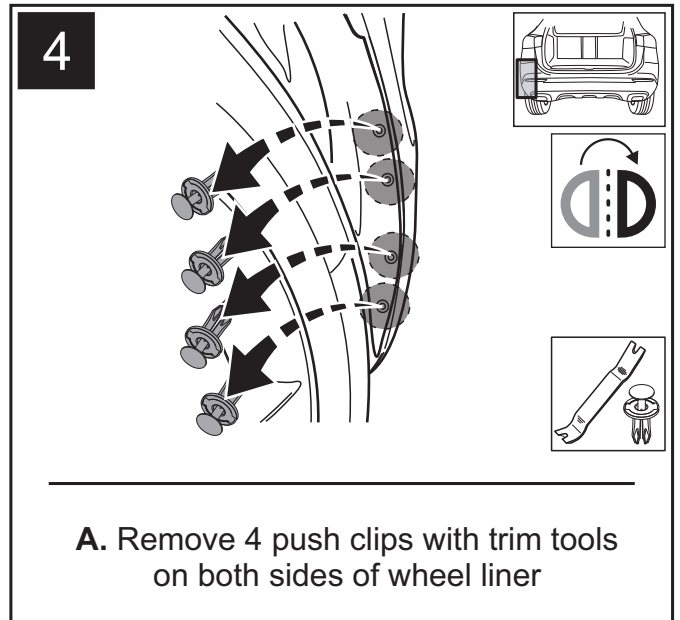

4
A. Remove 4 push clips with trim tools on both sides of wheel liner

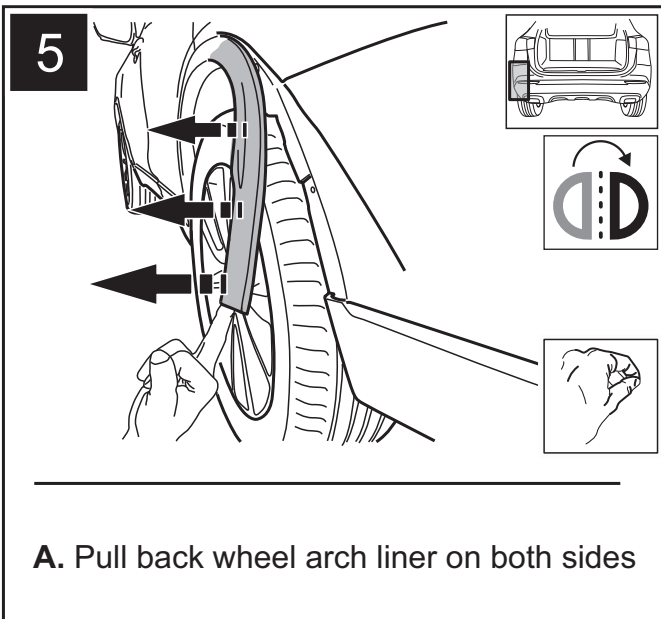

5
A. Pull back wheel arch liner on both sides

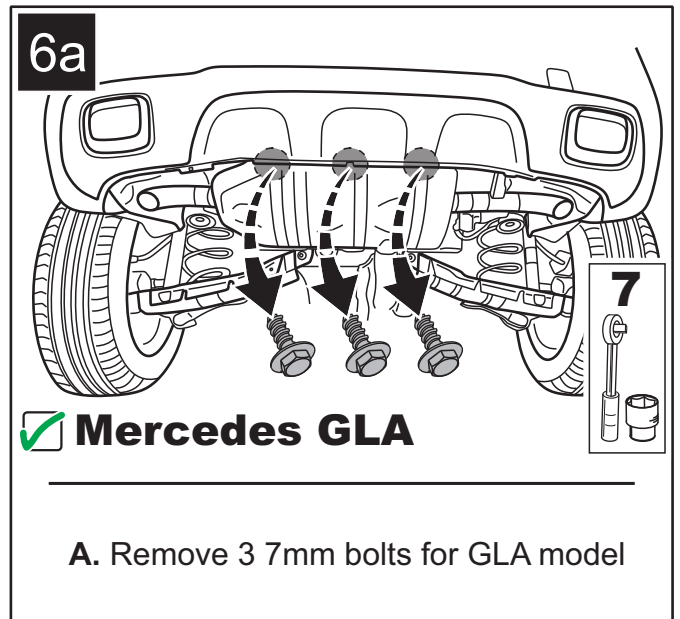

Mercedes GLA

6a
A. Remove 3 7mm bolts for GLA model

6b

Mercedes GLB

A. Remove 5 8mm bolts for GLB model

7

Mercedes GLB

A. Remove 2 push clips on each side of car for GLB model only

8

A. Remove 2 10mm bolts from underside of bumper

9

A. Remove bumper and disconnect wiring harness

10

A. Remove 6 16mm bolts holding in the crash beam

11

A. Remove crash beam and scrap it

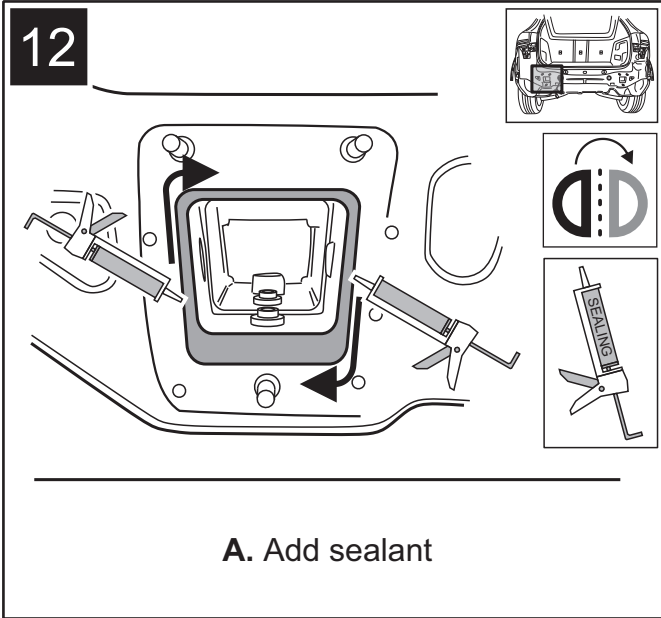

A. Add sealant

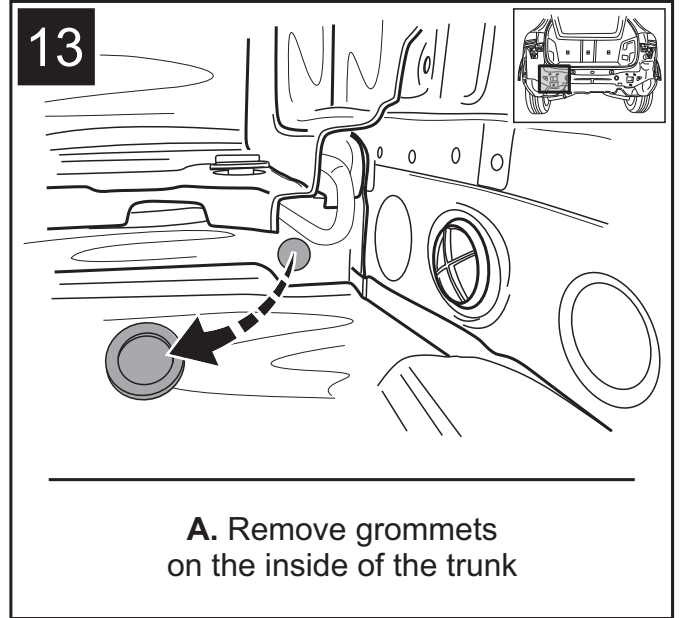

A. Remove grommets on the inside of the trunk

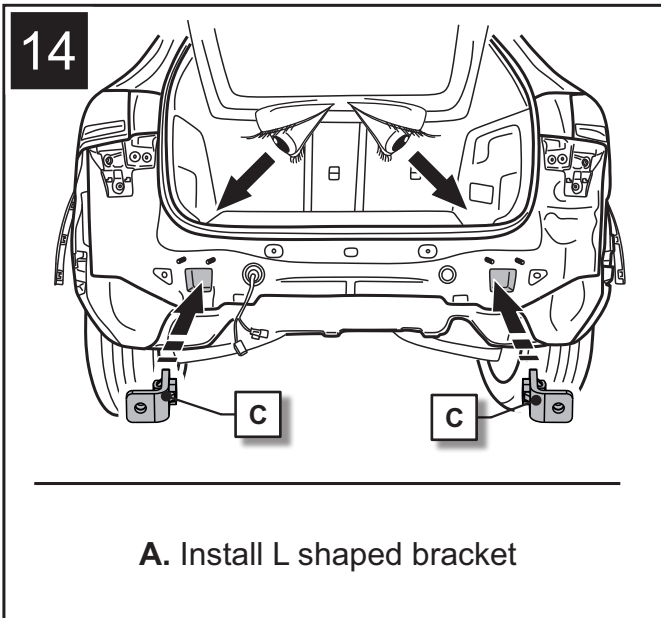

A. Install L shaped bracket

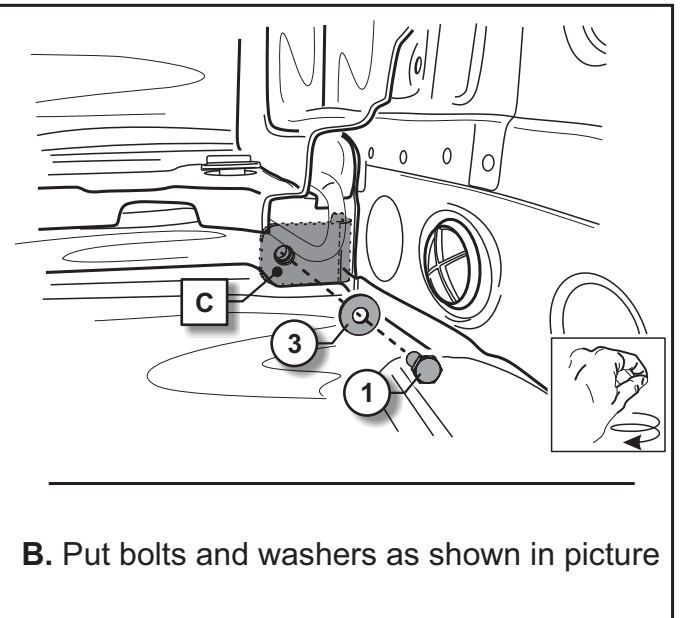

B. Put bolts and washers as shown in picture

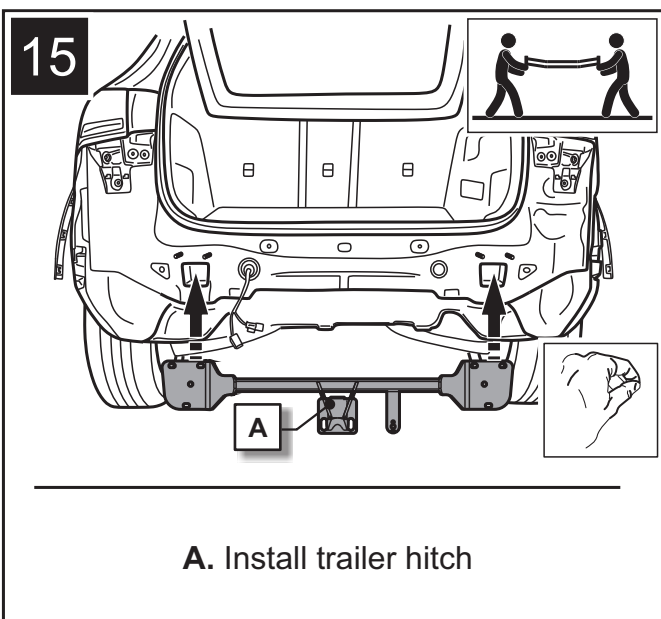

A. Install trailer hitch

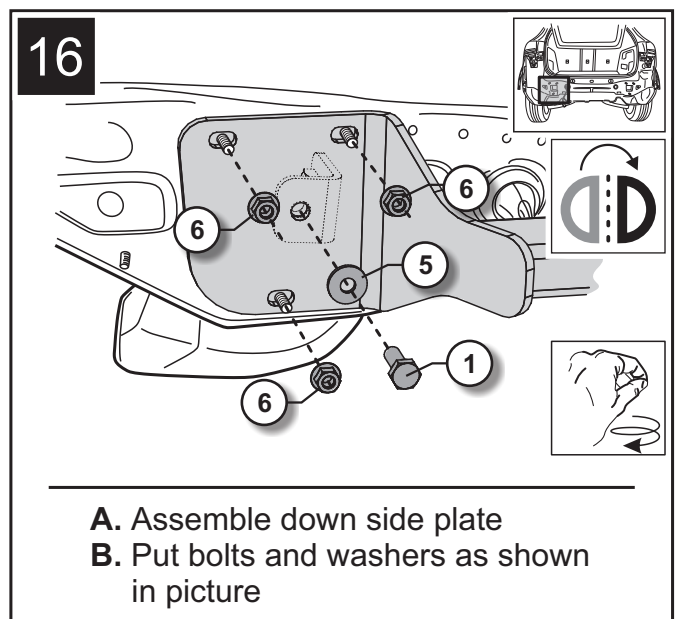

A. Assemble down side plate
B. Put bolts and washers as shown in picture

17

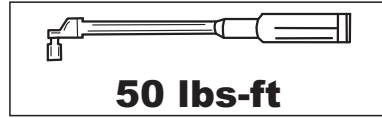
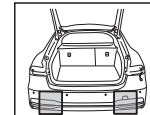
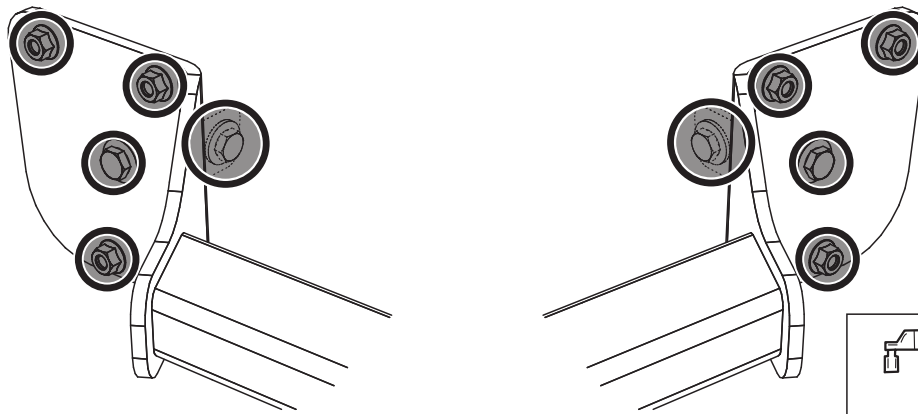

A. Tighten down side plate screw to 50 lbs-ft with the provided hardware

18

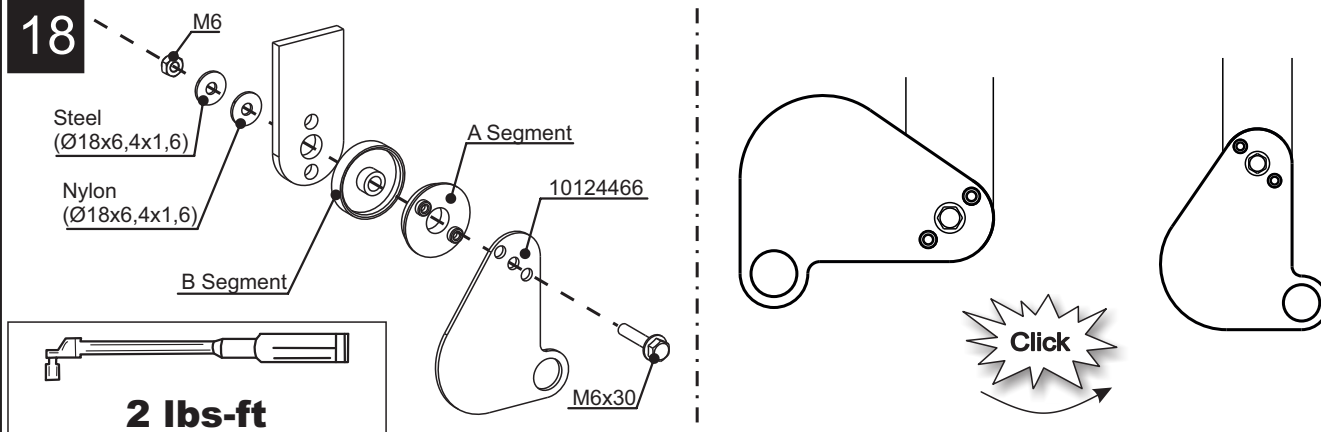

A. Assemble socket plate as shown in pictures and tighten to specifications provided (this is an optional plate for wiring harness)

19a

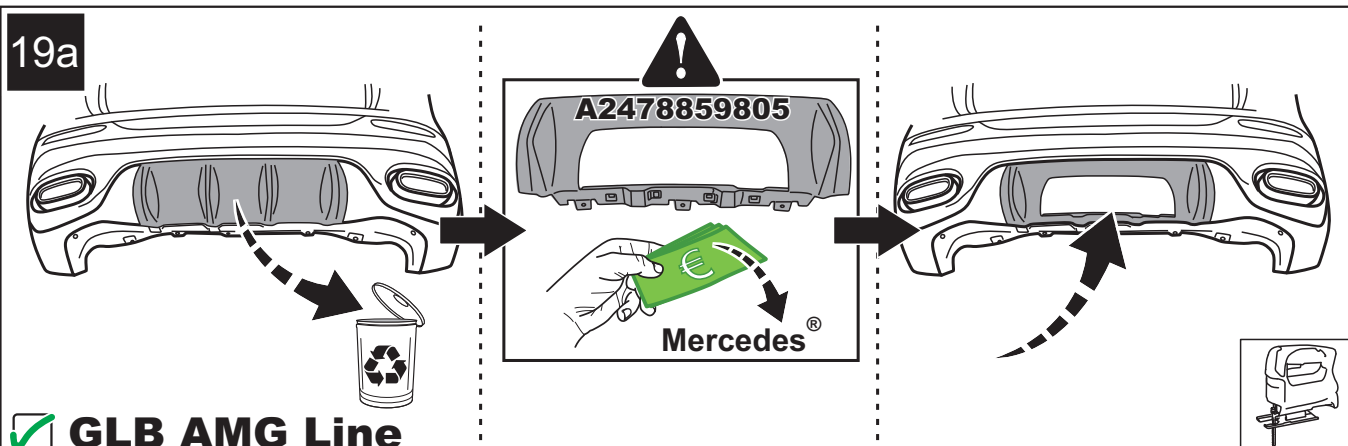

A. For GLB AMG line you can either cut the bumper for the cutout or buy oem bumper insert with cutout already done

19b



When making the cutout, please make sure to have enough clearance to operate hitch functions properly. This cutout is a guide, as some vehicle models will have slightly different build options.

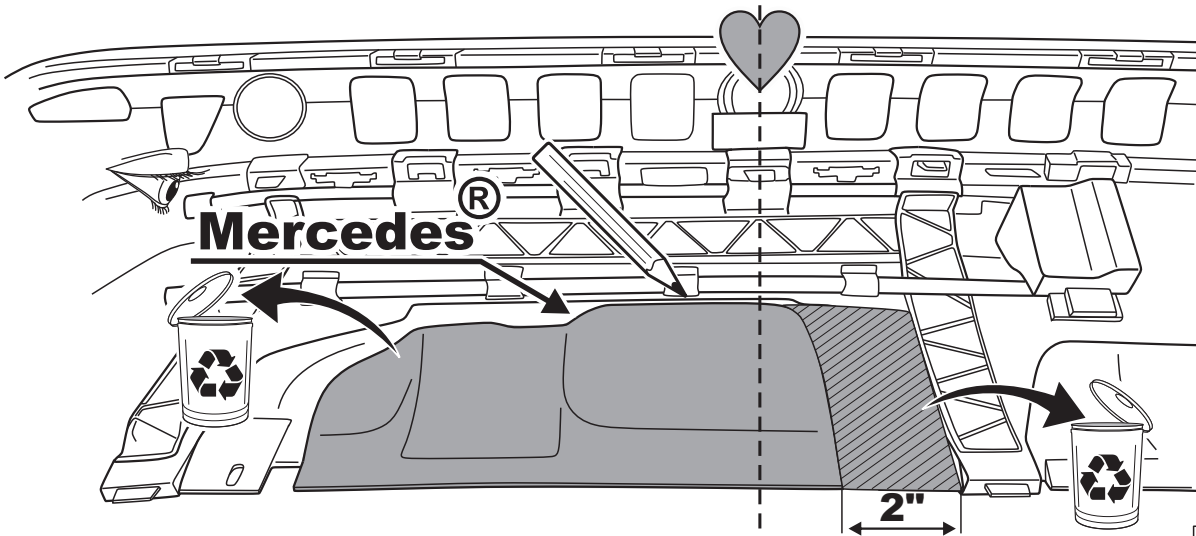
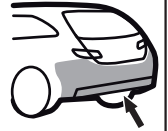

GLA Standard

GLB Standard



A. Make cutout in bumper following oem cutout template and add about 2 more inches for clearance

19c



When making the cutout, please make sure to have enough clearance to operate hitch functions properly. This cutout is a guide, as some vehicle models will have slightly different build options.

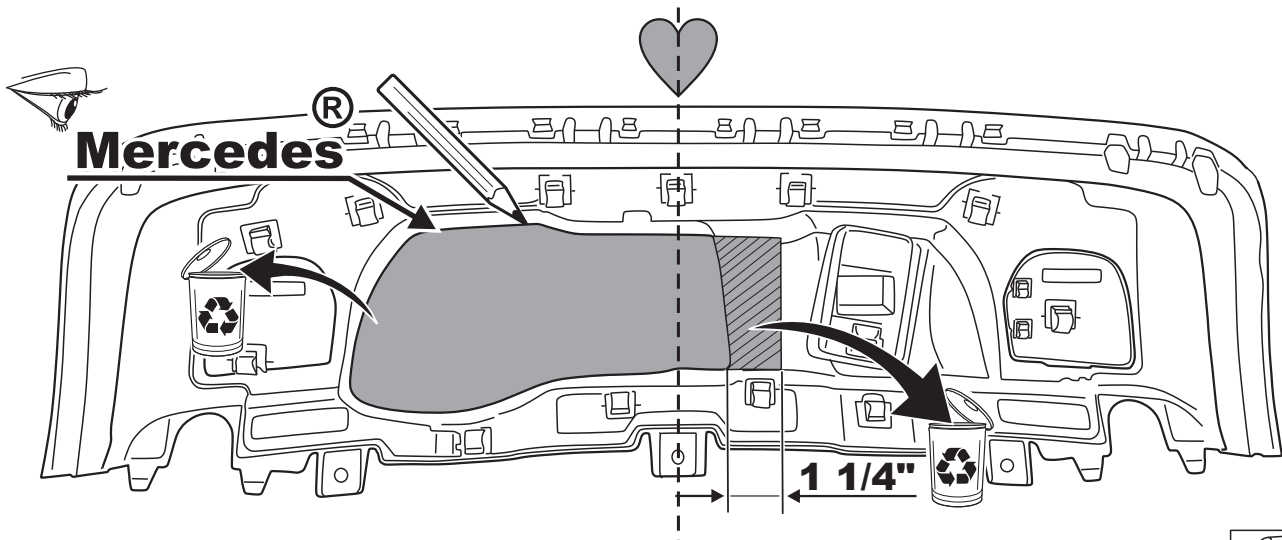
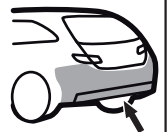

GLA Standard

GLB Standard



A. Make cutout in bumper following oem cutout template and add about 2 more inches for clearance

20

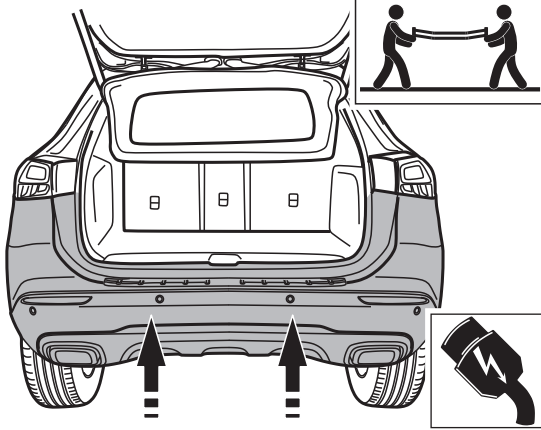

A. Reattach bumper and connect wiring harness

21

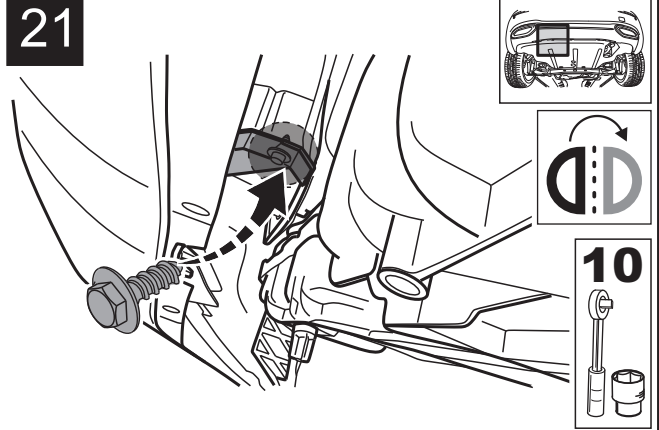

A. Reattach 2 10mm bolts to underside of bumper

22

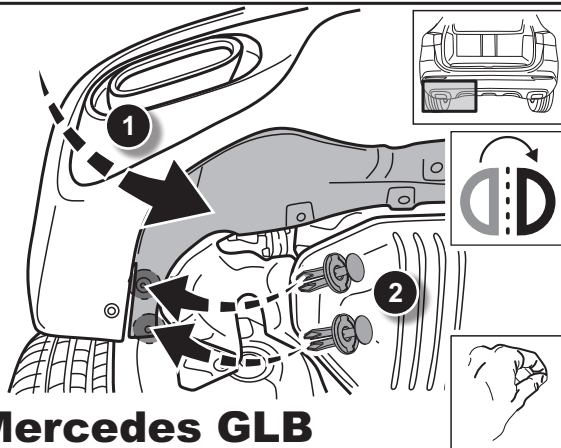

✓ Mercedes GLB

A. Reattach 2 push clips on each side of car for GLB model only

23a

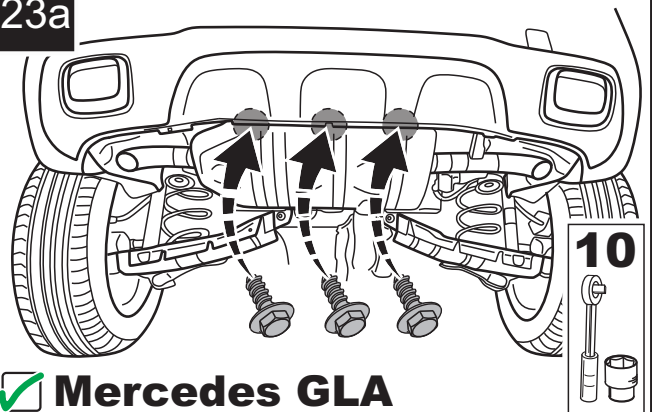

✓ Mercedes GLA

A. Reattach 3 7mm bolts for GLA model

23b

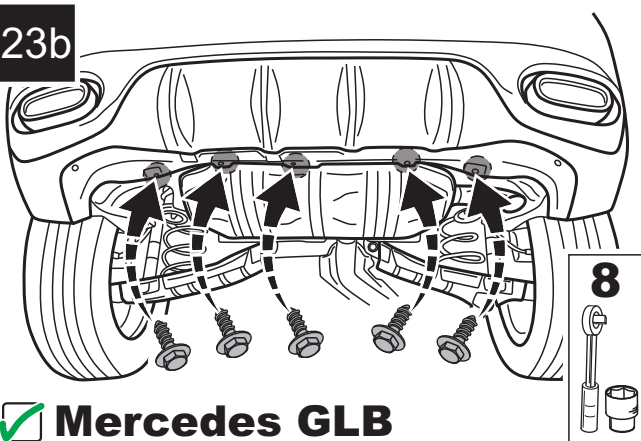

✓ Mercedes GLB

A. Reattach 5 8mm bolts for GLB model

24

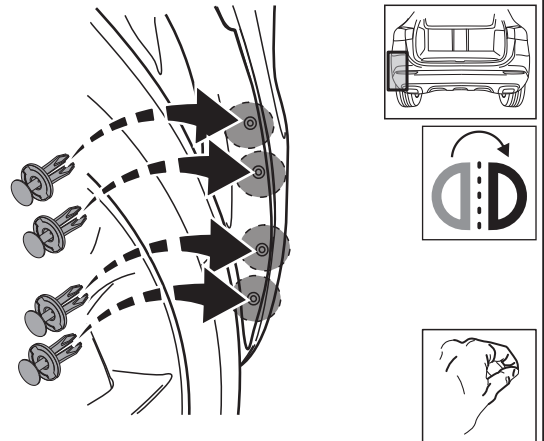

A. Reattach 4 push clips with trim tools on both sides of wheel liner

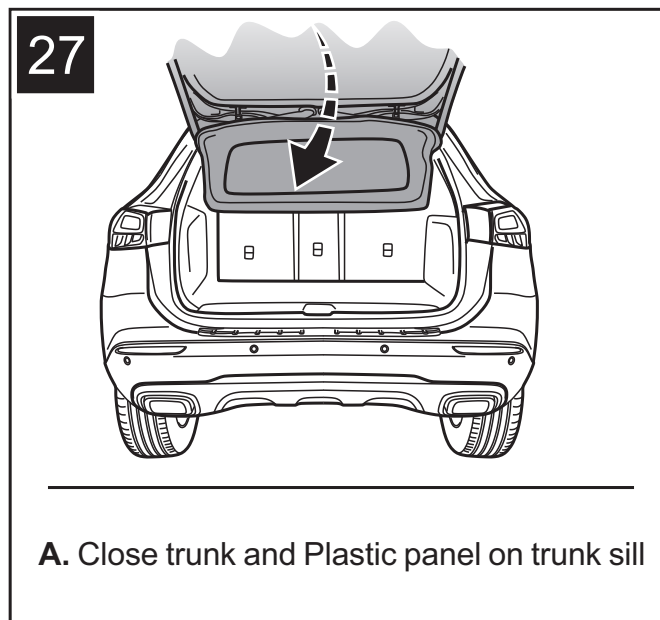
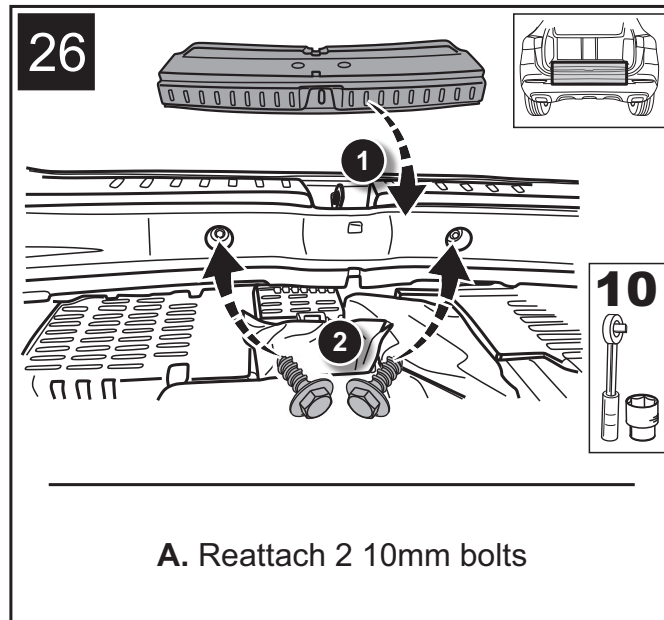
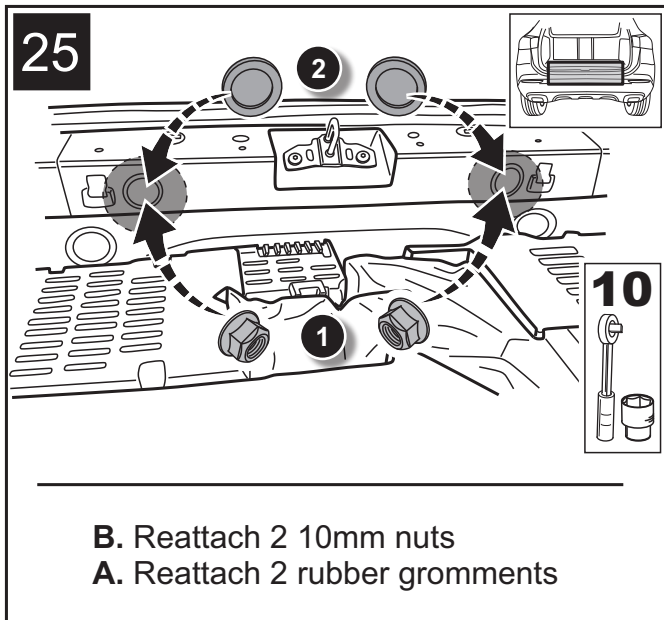

ORIS
ACPS

HELPLINE



www.oris-automotive.com/en/acps-automotive-aftermarket-worldwide

ORIS
ACPS