

Hitch, 2" Receiver, Toyota Highlander

INSTALLATION INSTRUCTIONS

READ ALL WARNINGS AND INSTRUCTIONS BEFORE INSTALLATION

⚠️WARNING: Never exceed the vehicle manufacturer's recommended towing capacity.

NOTICE:

- Always use proper tools and safety equipment to ensure a safe and quality installation.
- Inspection of the trailer hitch should be performed before and after each use to ensure all mounting hardware is tight and related hitch components are secure.

⚠️WARNING: Before you begin installation, read all instructions thoroughly.

⚠️WARNING: Safety glasses should be worn at all times while installing this product.

⚠️WARNING: Failure to adhere to exact torque specifications when securing hardware during the installation process can result in damage to the product or your vehicle. This will void the hitch warranty.

LEVEL OF DIFFICULTY: Easy

Installation difficulty levels are based on time and effort required. They will vary depending on the installer's expertise. Vehicle condition could be a factor in the level of difficulty for a proper installation.

WEIGHT CARRYING CAPACITY

Gross Trailer Weight (GTW)	5,000 lb
Tongue Weight (TW)	675 lb

WEIGHT DISTRIBUTION CAPACITY

Weight Distribution (WD)	NA
WD Tongue Weight (WDTW)	NA

PARTS LIST

Item	Qty	Description
1	6	Conical Washer ½, YZ
2	6	M12 x 1.25, 35, CL10.9, YZ

TOOLS REQUIRED

Safety Glasses
Ratchet
6" Extension
Torque Wrench
10mm Socket
12mm Socket
17mm Socket
19mm Socket
Screw Driver

* Rotary Tool (Optional)

ITEM	DESCRIPTION	QTY
2	1/2" CONICAL TOOTHED WASHER	6
1	M12 x 1.25 x 35 HEX HEAD CAP SCREW, CL10.9	6

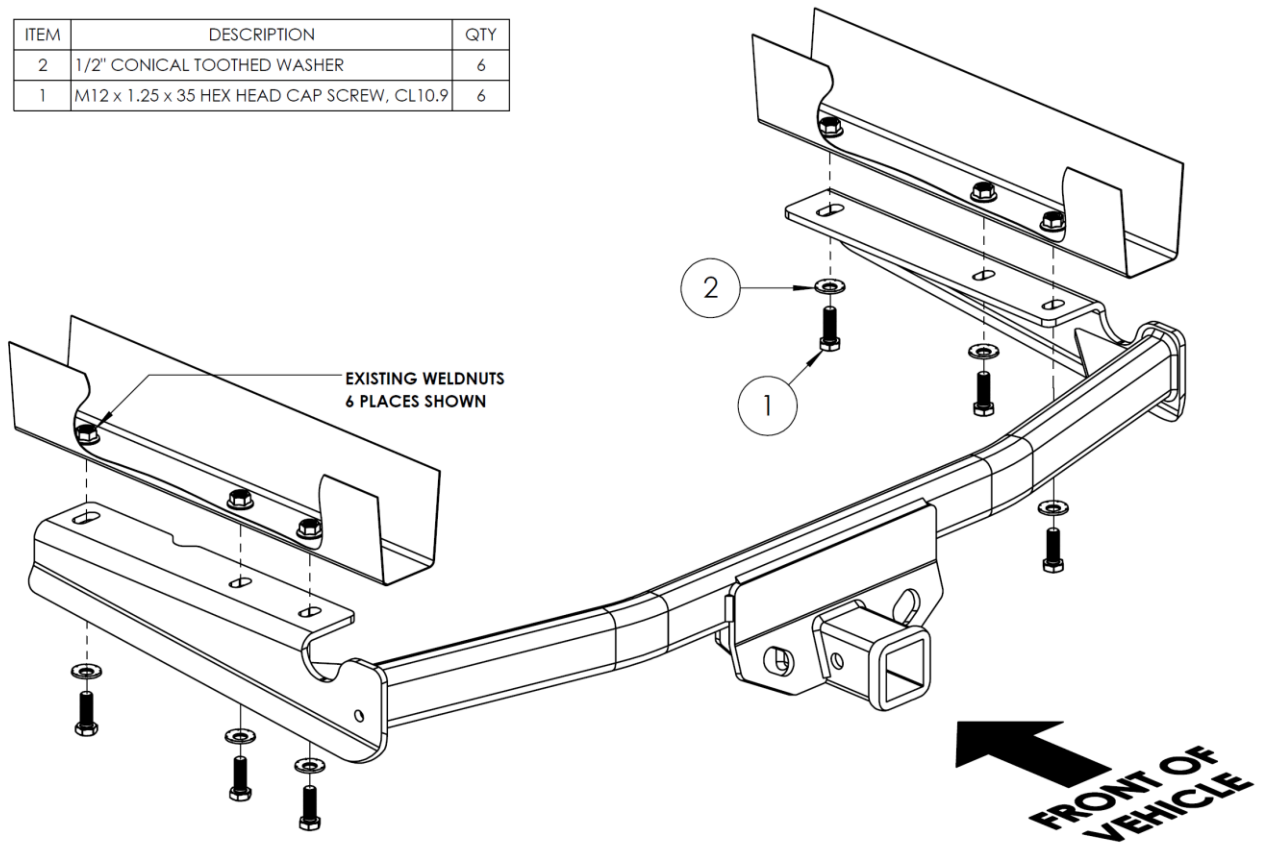

INSTALLATION:

Remove all 7 fasteners holding the driver-side underbody panel in place. After lowering, return to the owner or trim and reinstall in Step 5 if desired. Remove 1 fastener from each bumper support tab and bend downward.

1. Remove 2 rubber plugs from each frame rail. Unscrew 3 threaded plastic inserts from the driver-side frame rail and 2 from the passenger-side frame rail. Provide to vehicle owner.
2. Remove the M12 bolt securing the metal fascia tab to the passenger side frame rail. Return the fascia tab, tow loop, and fastener to the owner.
3. Lift the hitch over the exhaust then the fascia exhaust air deflector and align the holes with the weldnuts in the frame. Secure to the frame using the supplied M12-1.25 bolts and 1/2" conical washers. Torque all 12mm hardware to 86 ft-lbs. Reinstall the bumper fascia tabs removed in Step 1.
4. Mark and trim underbody panel. Reattach underbody panel using fasteners removed in Step 1 if desired.

NOTICE:

Dimensions of underbody trim panel diagram are approximate. Confirm fit before trimming. Ribs from underbody can be used as a cutting guide.

IF YOU EXPERIENCE ANY PROBLEMS WITH YOUR TOWSMART PRODUCT, DO NOT RETURN THE UNIT TO THE RETAILER FROM WHICH IT WAS PURCHASED. INSTEAD, PLEASE CALL 1-844-295-9215 FOR ASSISTANCE WITH ANY PROBLEMS. WARRANTY INFORMATION IS AVAILABLE UPON REQUEST AND CAN BE FOUND ONLINE AT TOWSMART.COM.

©02/2024



CUSTOM

A Winston Products Company
TOWSMART.COM
WINSTON PRODUCTS, LLC.
30339 Diamond Parkway
Cleveland, OH 44139