

## Hitch, 2" Receiver, Subaru Forester

### INSTALLATION INSTRUCTIONS

**READ ALL WARNINGS AND INSTRUCTIONS BEFORE INSTALLATION**

**⚠️WARNING:** Never exceed the vehicle manufacturer's recommended towing capacity.

**NOTICE:**

- Always use proper tools and safety equipment to ensure a safe and quality installation.
- Inspection of the trailer hitch should be performed before and after each use to ensure all mounting hardware is tight and related hitch components are secure.

**⚠️WARNING:** Before you begin installation, read all instructions thoroughly.

**⚠️WARNING:** Safety glasses should be worn at all times while installing this product.

**⚠️WARNING:** Failure to adhere to exact torque specifications when securing hardware during the installation process can result in damage to the product or your vehicle. This will void the hitch warranty.

**LEVEL OF DIFFICULTY:** Easy

Installation difficulty levels are based on time and effort required. They will vary depending on the installer's expertise. Vehicle condition could be a factor in the level of difficulty for a proper installation.

**WEIGHT CARRYING CAPACITY**

Gross Trailer Weight (GTW)	4,500 lb
Tongue Weight (TW)	675 lb

**WEIGHT DISTRIBUTION CAPACITY**

Weight Distribution (WD)	NA
WD Tongue Weight (WDTW)	NA

**PARTS LIST**

Item	Qty	Description
1	6	Carriage Bolt, 1/2-13 UNC, 1-3/4, G8, YZ
2	6	Square Hole Spacer 2.5" x 1" x .25"
3	6	Flange Nut, 1/2-13 UNC, G8, YZ
4	6	1/2" Fishwire

**TOOLS REQUIRED**

Safety Glasses
Ratchet
10mm 3/4" Socket
Phillips Head Screwdriver
Torque Wrench
6" Socket Extension
Die Grinder

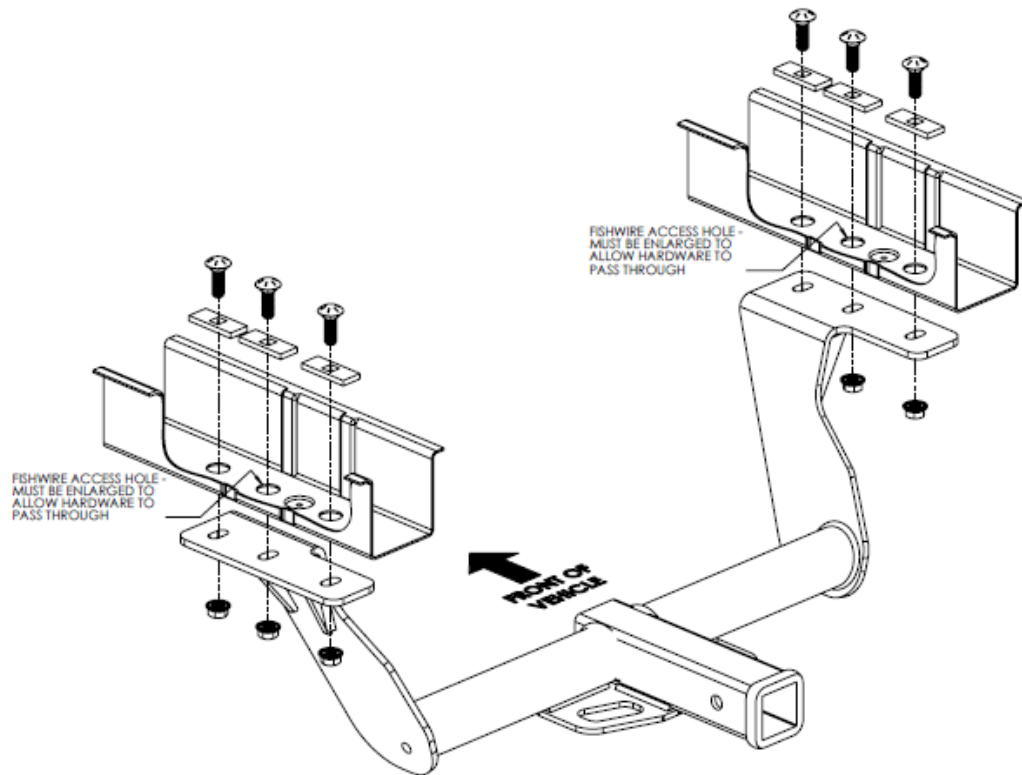

## INSTALLATION:

1. Remove the two exhaust hangers from the passenger-side muffler and one exhaust hanger from the vehicle's center for models with a single exhaust system. Remove two exhaust hangers from the driver-side muffler as well if the model is equipped with a dual exhaust system. Always support the lowered exhaust system.
2. Remove four heat shield components with phillips head screwdriver or 10mm socket (both sides if equipped with dual exhaust and proceed to Step 3). Remove the underbody panel from driver-side frame rail by removing two screws and five push fasteners. You will reinstall this later.
3. Remove three hole-plugs from each frame rail to expose mounting holes. Provide removed plugs to the vehicle owner. Enlarge the center hole on each side of the frame rail to about 1 1/8" to allow the mounting hardware to pass through.
4. Fishwire 1/2" carriage bolt and spacer through the front and rear frame holes in both frame sides. Second, reverse Fishwire the center hole both sides.
  1. Optional: Drill 5/8" holes in the heat shield using dimples as guides and reinstall heat shield without rearmost frame attachment.
5. Lift hitch into position and secure hitch to frame using the 1/2" hardware provided. Torque all hardware to 110 ft-lbs. Reinstall the underbody panel removed in Step 2 and the exhaust removed in Step 1.

IF YOU EXPERIENCE ANY PROBLEMS WITH YOUR TOWSMART PRODUCT, DO NOT RETURN THE UNIT TO THE RETAILER FROM WHICH IT WAS PURCHASED. INSTEAD, PLEASE CALL 1-844-295-9215 FOR ASSISTANCE WITH ANY PROBLEMS. WARRANTY INFORMATION IS AVAILABLE UPON REQUEST AND CAN BE FOUND ONLINE AT TOWSMART.COM.

©02/2024



**CUSTOM**

A Winston Products Company  
 TOWSMART.COM  
 WINSTON PRODUCTS, LLC.  
 30339 Diamond Parkway  
 Cleveland, OH 44139