

Hitch, 2” Receiver Ford Escape

INSTALLATION INSTRUCTIONS

READ ALL WARNINGS AND INSTRUCTIONS BEFORE INSTALLATION

⚠️WARNING: Never exceed the vehicle manufacturer’s recommended towing capacity.

NOTICE:

- Always use proper tools and safety equipment to ensure a safe and quality installation.
- Inspection of the trailer hitch should be performed before and after each use to ensure all mounting hardware is tight and related hitch components are secure.

⚠️WARNING: Before you begin installation, read all instructions thoroughly.

⚠️WARNING: Safety glasses should be worn at all times while installing this product.

⚠️WARNING: Failure to adhere to exact torque specifications when securing hardware during the installation process can result in damage to the product or your vehicle. This will void the hitch warranty.

LEVEL OF DIFFICULTY: Easy

Installation difficulty levels are based on time and effort required. They will vary depending on the installer’s expertise. Vehicle condition could be a factor in the level of difficulty for a proper installation.

WEIGHT CARRYING CAPACITY

| | |
|----------------------------|----------|
| Gross Trailer Weight (GTW) | 4,500 lb |
| Tongue Weight (TW) | 675 lb |

WEIGHT DISTRIBUTION CAPACITY

| | |
|--------------------------|----|
| Weight Distribution (WD) | NA |
| WD Tongue Weight (WDTW) | NA |

PARTS LIST

| Item | Qty | Description |
|------|-----|--|
| 1 | 6 | Flange Nut, ½-13, GRD8, YZ |
| 2 | 6 | Square Hole Spacer .250 x 1.00 x 2.50” |
| 3 | 6 | ½-13 x 1 1/4 Carriage Bolt GRD8, YZ |
| 4 | 6 | ½” Fishwire |

TOOLS REQUIRED

| |
|---------------------|
| Safety Glasses |
| Ratchet |
| 6” Socket Extension |
| Torque Wrench |
| ¾” Socket |
| Die Grinder |
| Marking Tool |

INSTALLATION:

1. Lower exhaust while ensuring it is supported to create additional space when installing hitch.
2. Temporary lift hitch into position while aligning the mounting holes of hitch with mounting holes in vehicle frame. Mark the location of forwardmost mounting holes. Lower hitch and enlarge the vehicle mounting holes where marked using die grinder. Consider lower the exhaust for greater ease.
3. Fishwire 2 spacers and 2 1/2" carriage bolts through enlarged hole and out the mounting holes on each side. Reverse fishwire 1 spacer and 1 1/2" carriage bolt through and out the enlarged hole on both sides of vehicle. Use fishwire and Reverse Fishwire Diagrams as reference.
4. Lift hitch into position and secure to vehicle using 1/2" flange nuts.
5. Torque all 1/2" hardware to 110 lb-ft.

* Some facial trimming maybe required.

| ITEM | DESCRIPTION | QTY |
|------|---------------------------------------|-----|
| 1 | 1/2-13 UNC x 1-1/4 CARRIAGE BOLT; GR8 | 6 |
| 2 | 1/4 X 1 X 2-1/2 SQUARE HOLE SPACER | 6 |
| 2 | 1/2-13 UNC SERRATED FLANGE NUT; GR8 | 6 |
| 1 | 1/2" FISHWIRE | 6 |

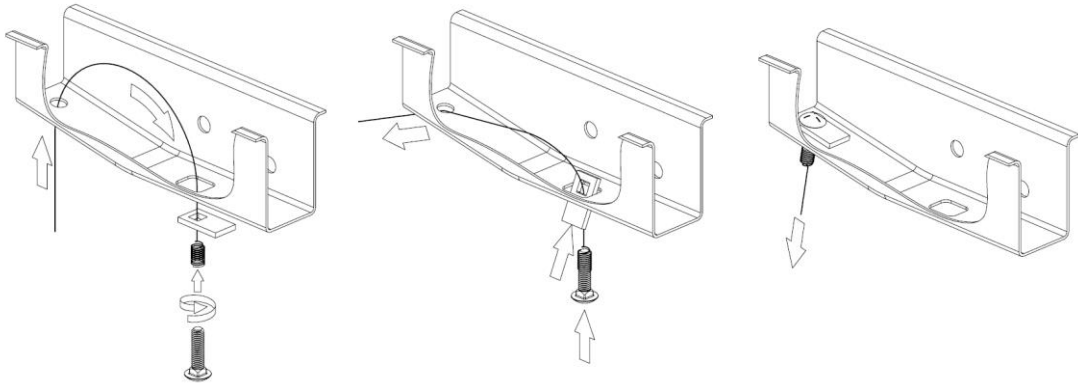
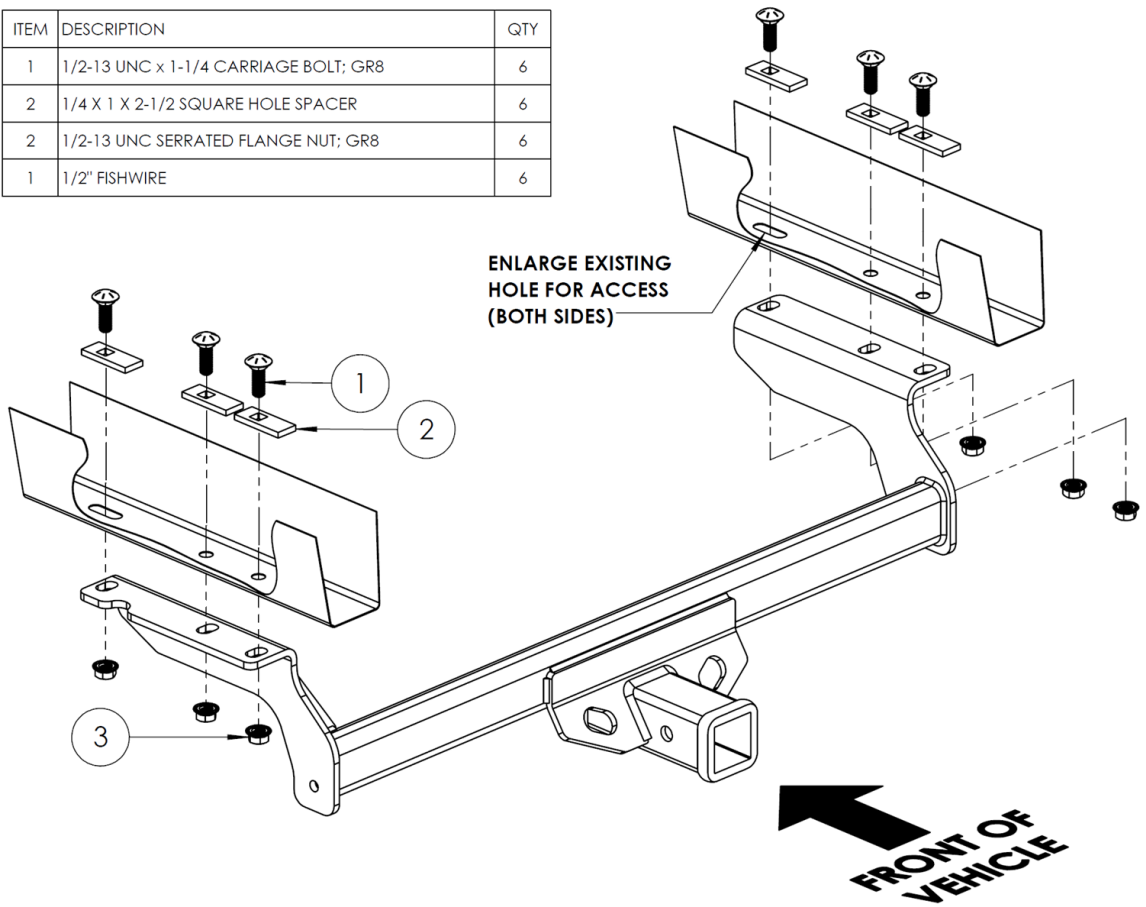

FISH WIRE TECHNIQUE

1. Insert the coiled end of the fish wire tool through the mounting hole in the vehicle frame rail and out the access hole.
2. Thread the coiled end of the fish wire through the spacer and thread the bolt into the coil.
3. Kink the wire to keep the spacer separate from the bolt.
4. Pull the spacer and bolt through the frame and out the mounting hole.
5. Keep the fish wire secure to prevent loss of the bolt or spacer inside the frame rail.

IF YOU EXPERIENCE ANY PROBLEMS WITH YOUR TOWSMART PRODUCT, DO NOT RETURN THE UNIT TO THE RETAILER FROM WHICH IT WAS PURCHASED. INSTEAD, PLEASE CALL 1-844-295-9215 FOR ASSISTANCE WITH ANY PROBLEMS. WARRANTY INFORMATION IS AVAILABLE UPON REQUEST AND CAN BE FOUND ONLINE AT TOWSMART.COM.



A Winston Products Company
TOWSMART.COM
WINSTON PRODUCTS, LLC.
30339 Diamond Parkway
Cleveland, OH 44139