

Part Number: 200916

Cadillac XT4

2020 -

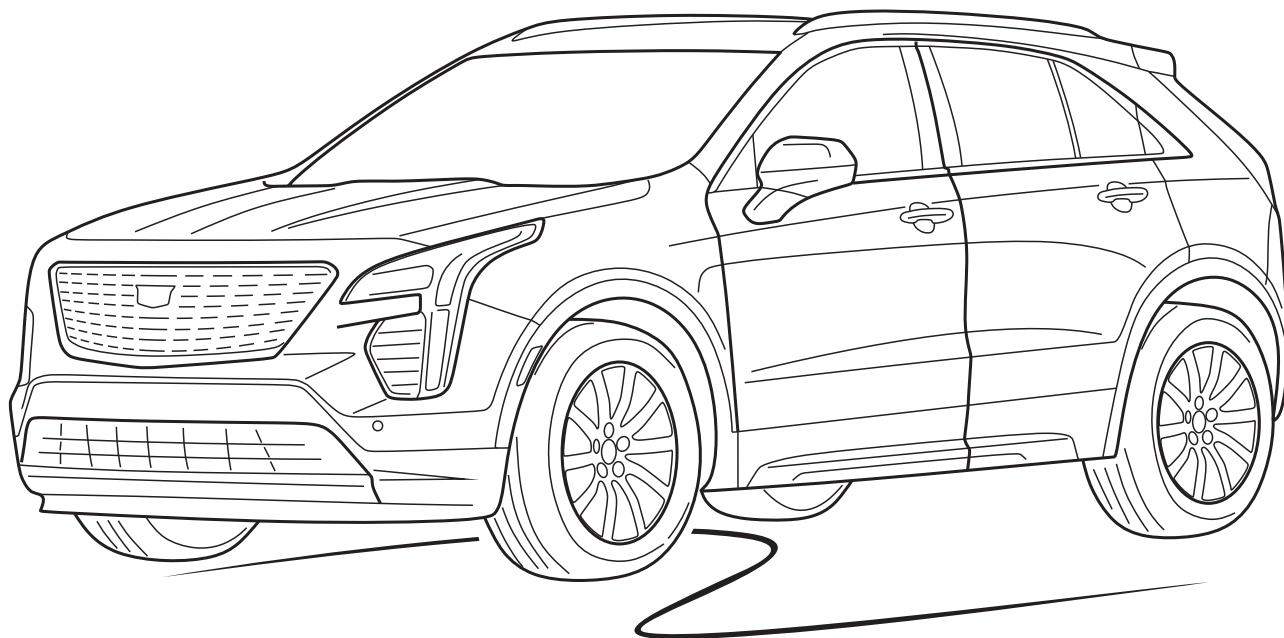
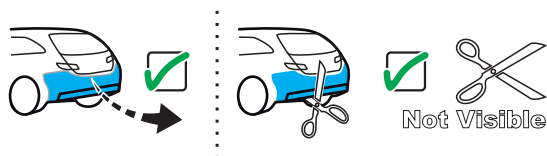

Check our webpage for the latest and a full-color copy of this fitting instruction.

[www.oris-automotive.com/en/](http://www.oris-automotive.com/en/)

Version: 02  
Date: 08-05-2025



**THESE INSTRUCTIONS MUST BE GIVEN TO THE END USER**

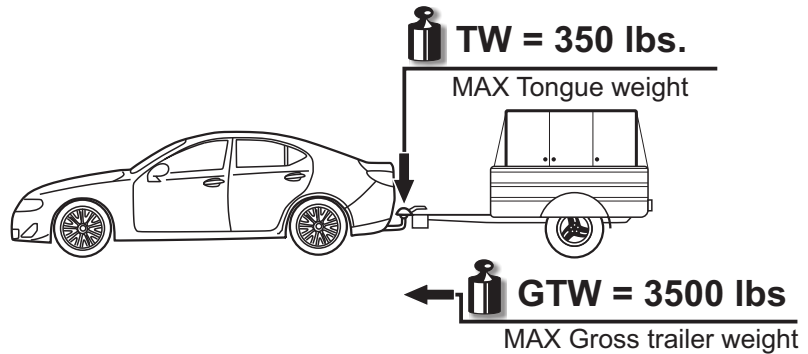
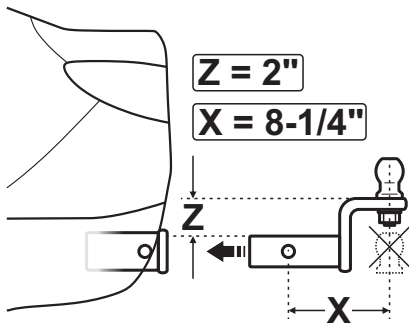

**Never exceed the vehicle or the hitch manufacturer's recommended towing capacity and tongue weight.**



### **IMPORTANT SAFETY NOTICE FOR HITCH INSTALLERS AND CUSTOMERS**

Read all installation, operating and safety instructions along with all labels before installing or using this product. Failure to comply with the safety information could result in serious injury or death.



[www.oris-automotive.com/en/safety/](http://www.oris-automotive.com/en/safety/)



**WARNING:** This product can expose you to chemicals including carbon black, which is known to the State of California to cause cancer. For more information go to [www.P65Warnings.ca.gov](http://www.P65Warnings.ca.gov)



**WARNING:** Do not perform any installation or towing procedures without fully understanding the correct tools and actions for all steps. Call for support if needed.



[www.oris-automotive.com/en/acps-automotive-aftermarket-worldwide/](http://www.oris-automotive.com/en/acps-automotive-aftermarket-worldwide/)

## Legend / Légende / Leyenda



US Attention  
F Attention  
E Atención



US Incorrect  
F Incorrect  
E Incorrecto



US Correct  
F Correct  
E Correcto



US Inspect  
F Examiner  
E Revise

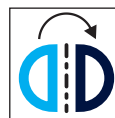

US In both sides  
F Tous les deux côtés  
E En ambos lados



US Manually  
F À la main  
E A mano

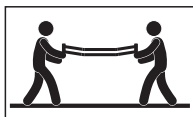

US Only 2 persons may carry out  
F Toujours s'y mettre de deux  
E Operación que requiere dos personas



US Remove  
F Rebuter  
E Tratamiento de residuos



US Location/Position  
Arrow  
F Flèche de Position  
E Flecha de posición



US Movement Arrow  
F Flèche de mouvement  
E Flecha de movimiento



US Protect it against corrosion  
F Protéger contre la corrosion  
E Proteger contra la corrosión



US Electrical connection  
F Connexion électrique  
E Conexión eléctrica

## Tools Required / Outils requis / Herramientas requeridas

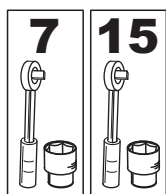

**7 15**  
RATCHET  
WITH  
SOCKET

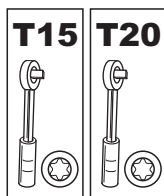

**T15 T20**  
TORX



**lbs-ft**  
TORQUE WRENCH  
WITH SOCKET 10, 17, 19



CUTTING  
TOOL



PLASTIC  
PRY

## Safety / Sécurité / Seguridad

Should be worn at all times  
while installing this product.

Il doit être porté en permanence  
lors de l'installation de ce produit.



Debe llevarse en todo momento  
mientras se instala este producto.

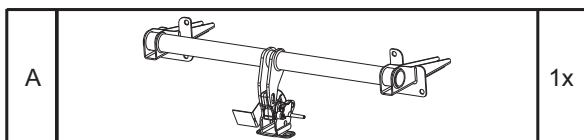
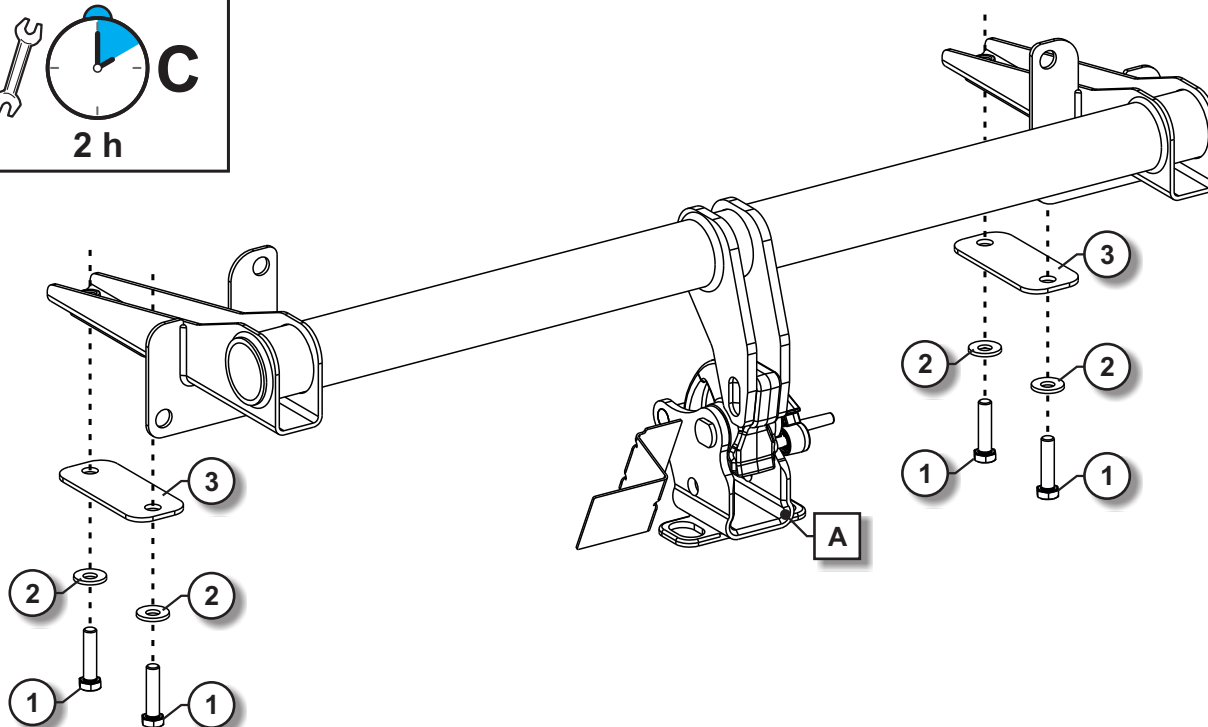
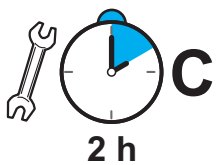

## Assembly / Assemblage / Montaje

## Mounting time



1		M12x50	10.9	4x	86 lbs-ft
2		M12		4x	
3				2x	

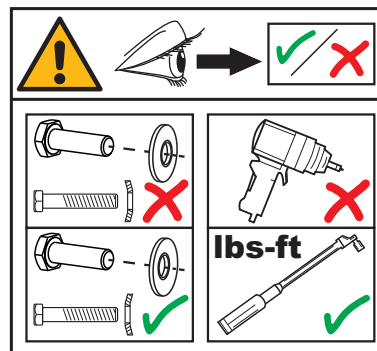

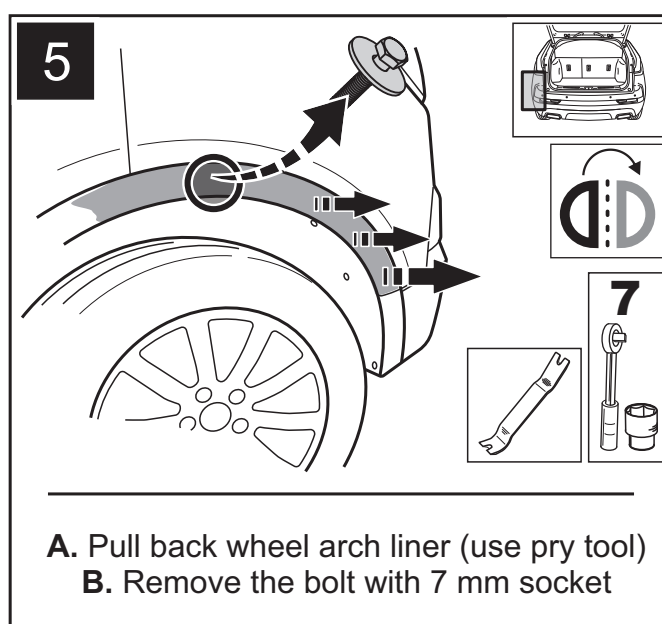
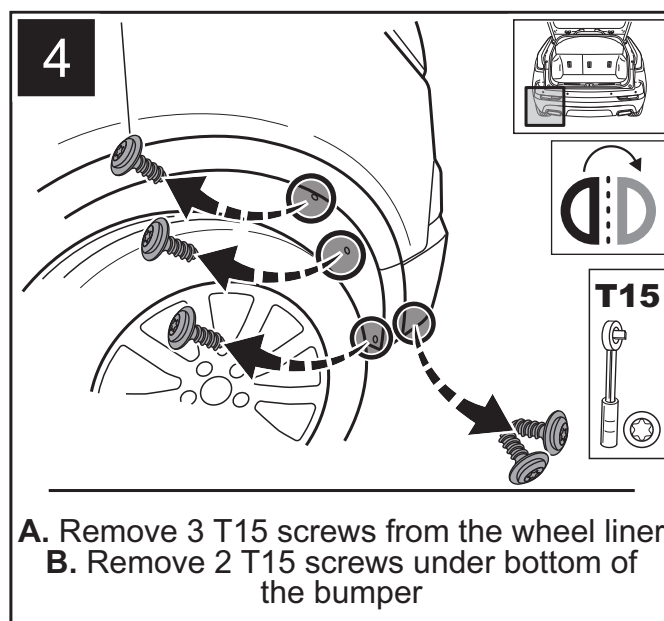
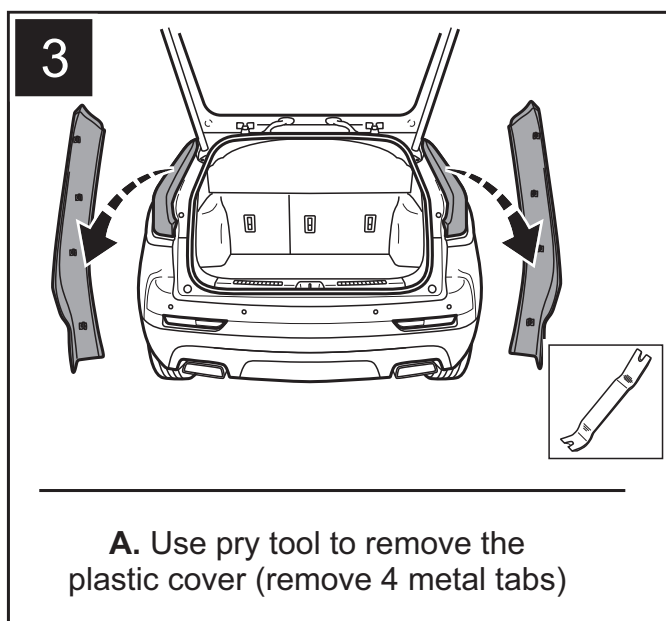
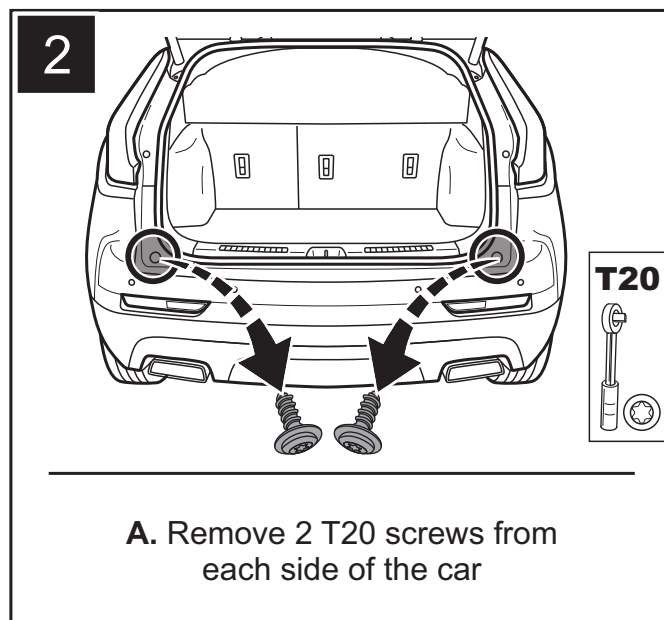
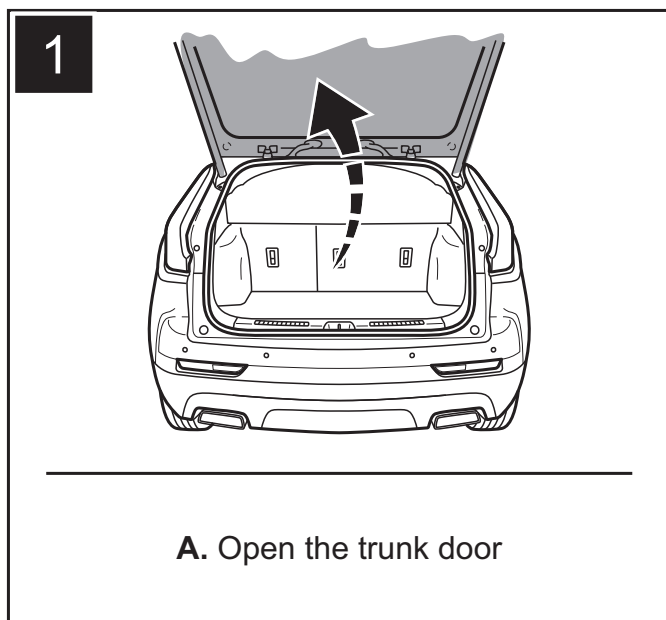

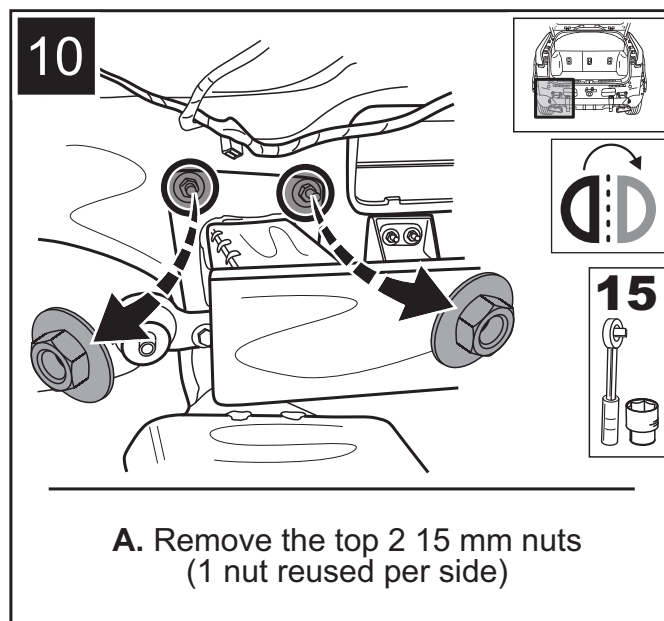
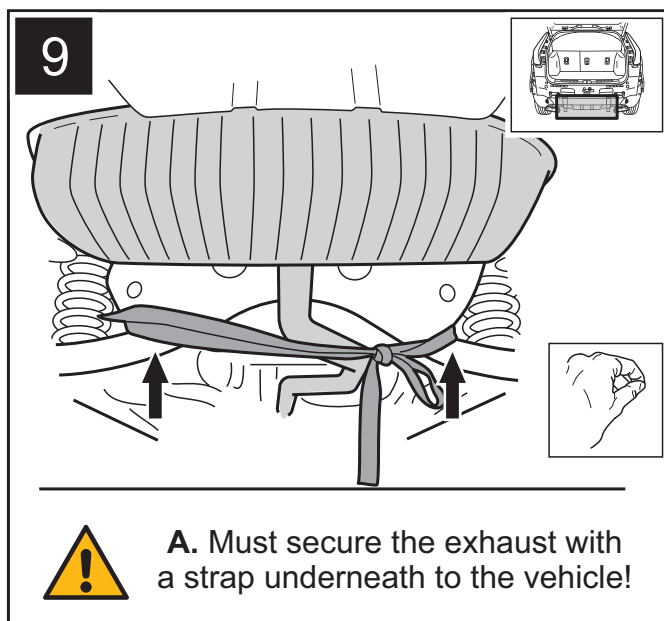
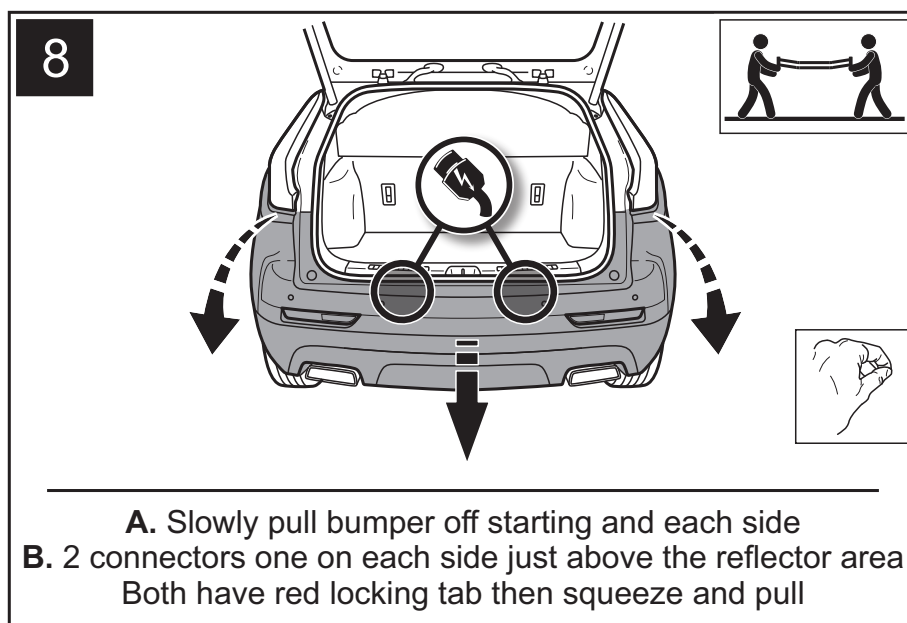
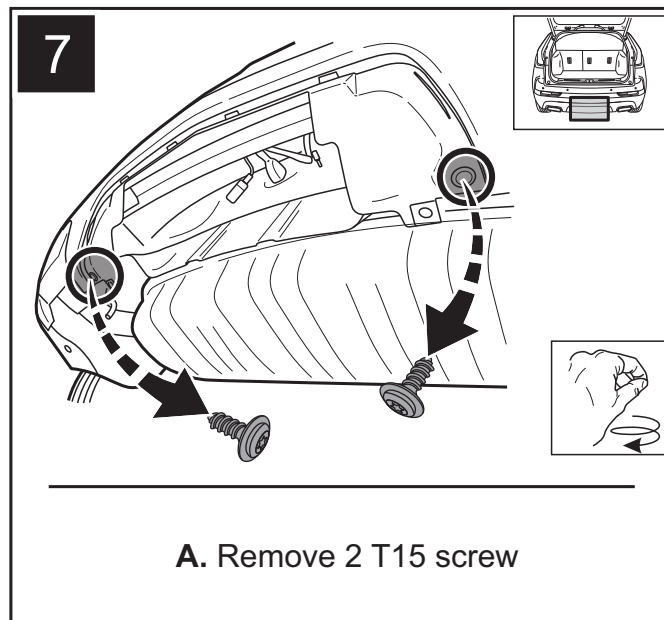
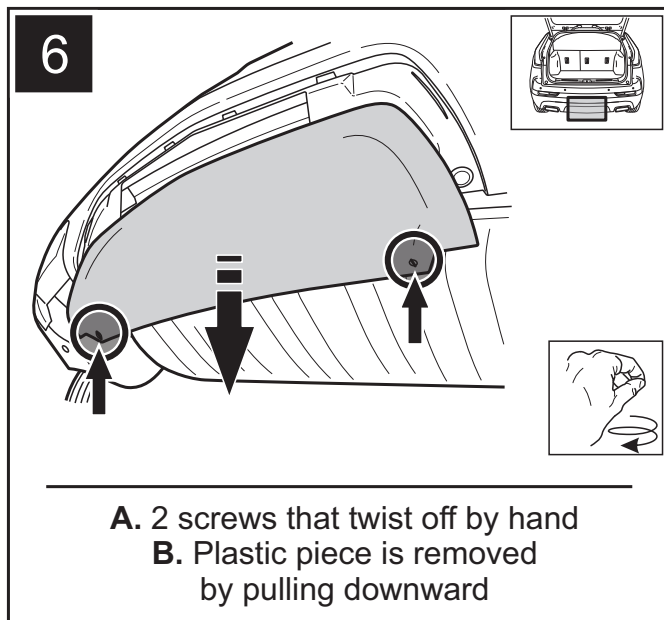

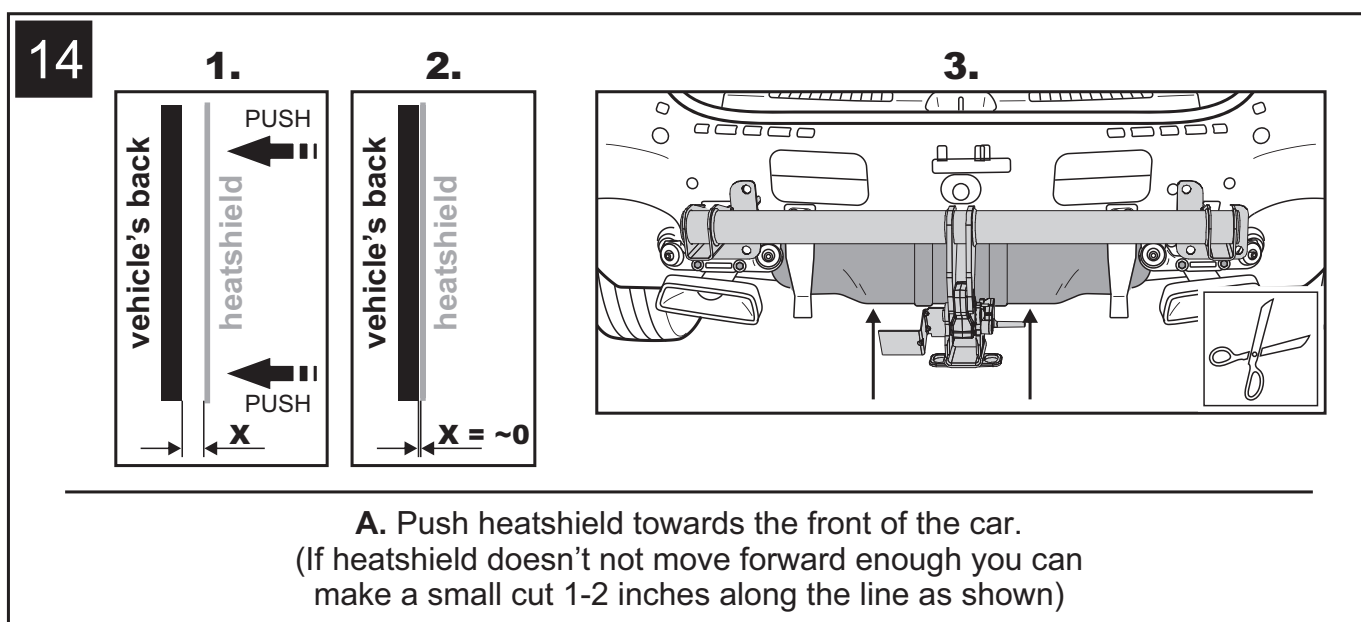
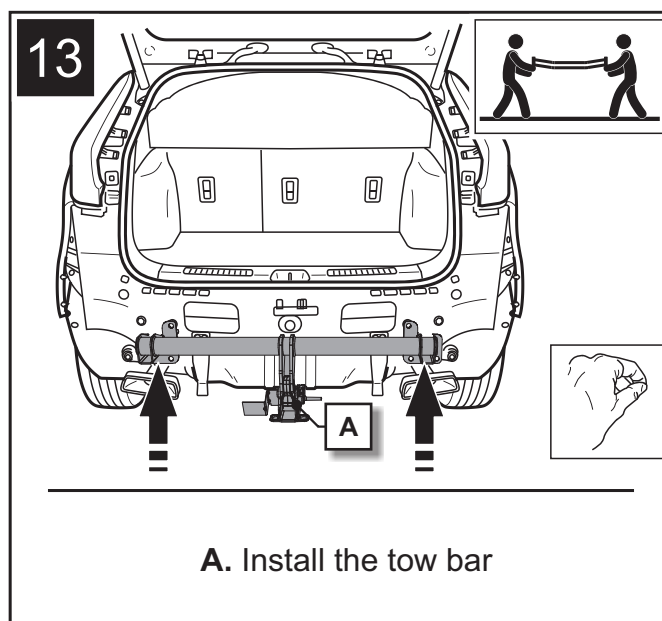
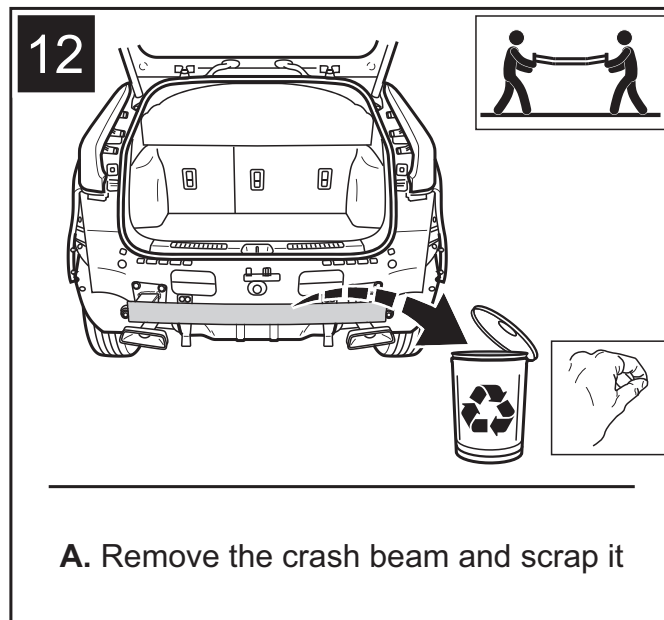
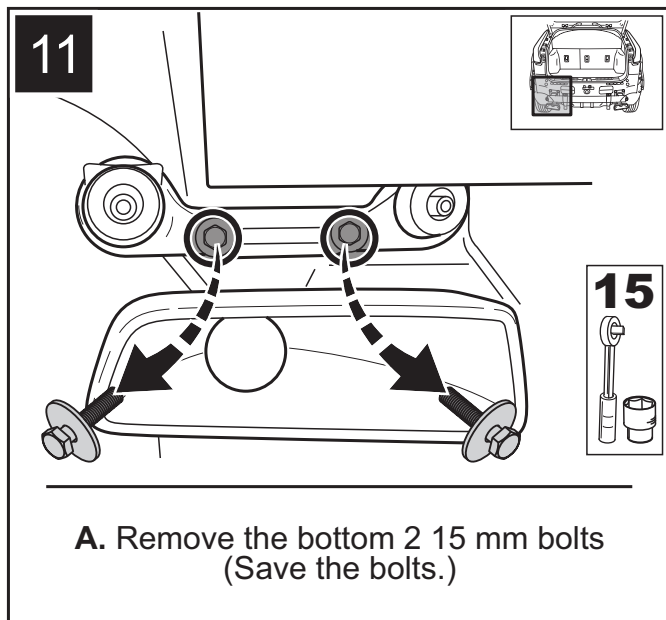



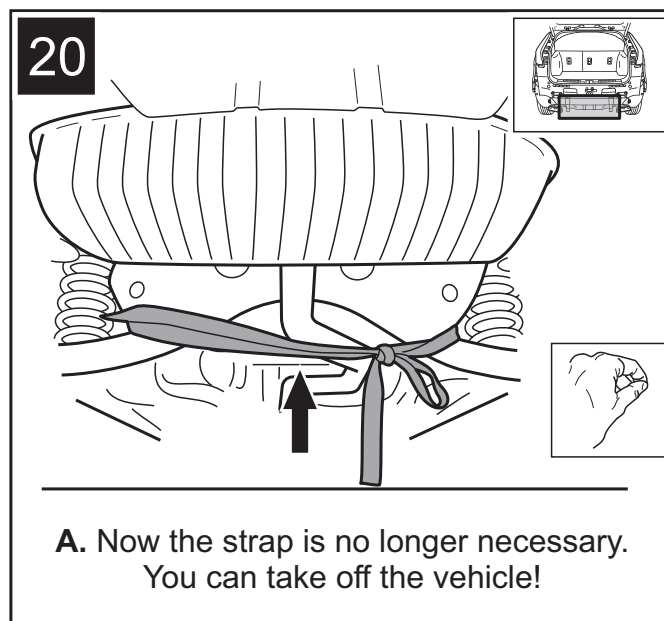
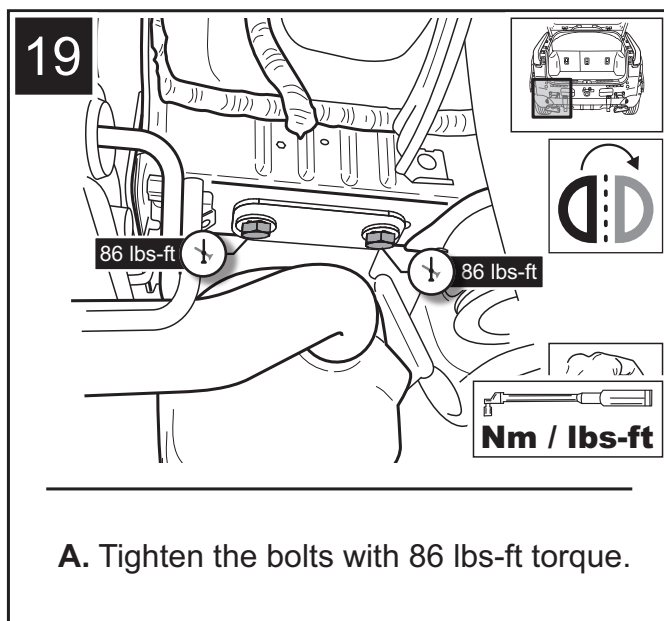
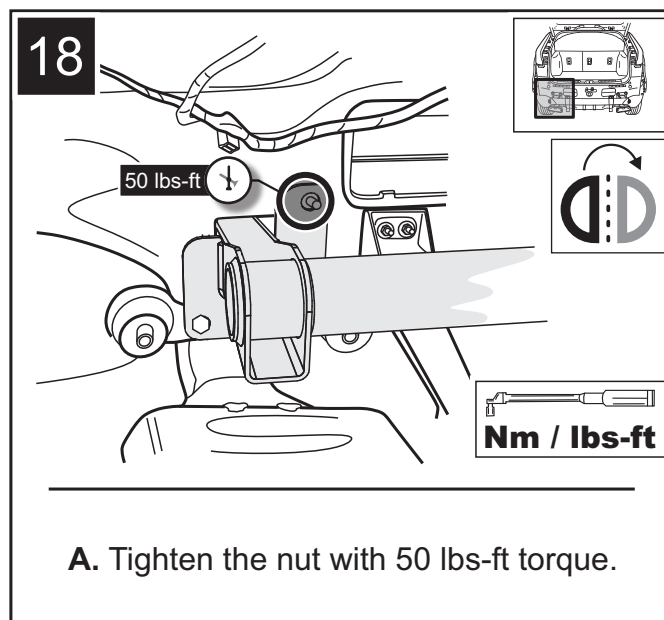
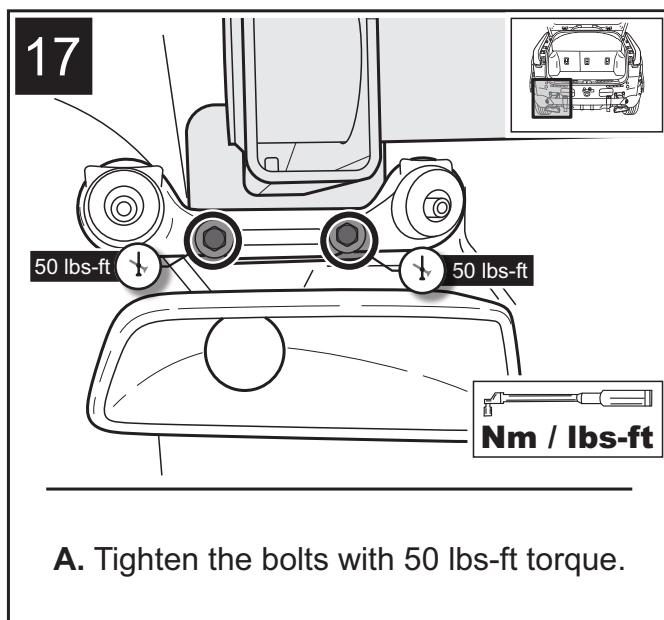
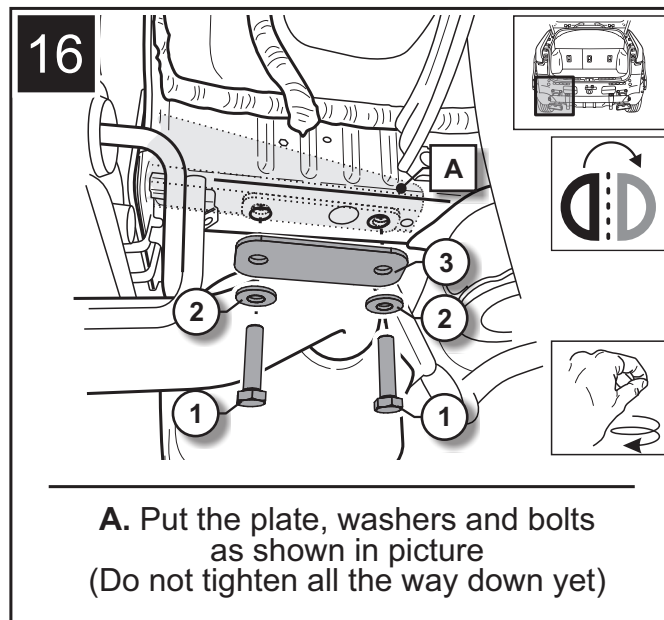
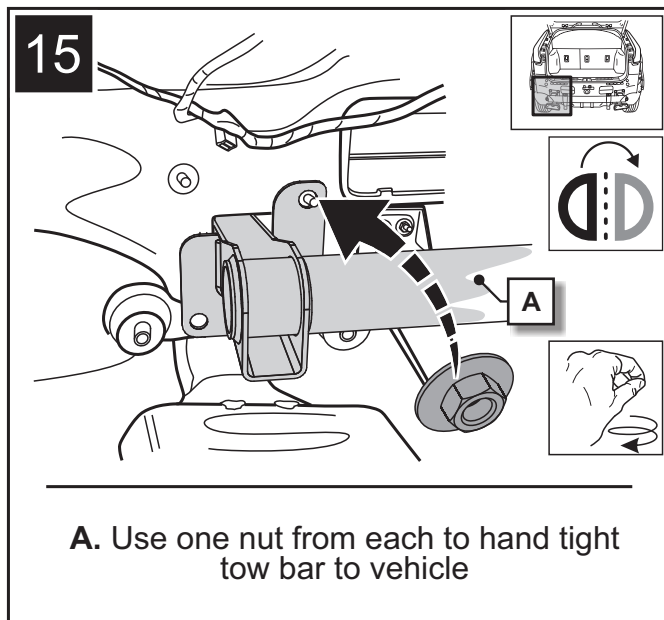



21

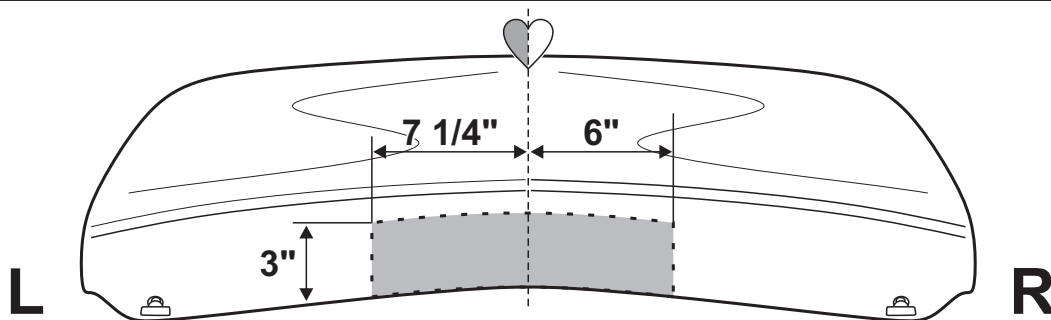

When making the cutout, please make sure to have enough clearance to operate hitch functions properly. This cutout is a guide, as some vehicle models will have slightly different build options.

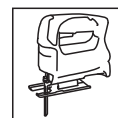

**A.** Make a cut out on plastic piece.using tool of choice (Dremel, oscillating tool, etc.) and diagram provided. (The front edge needs to follow the curve of the panel /approximately 3 in/. You can also trim more after if needed, don't over cut on the first attempt. Do not cut above the horizontal plane of the bottom.)

22

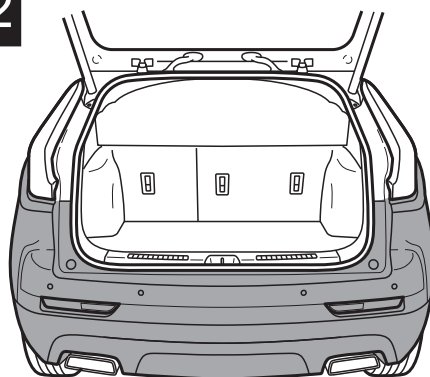

7 → 1

**A.** Reattach the bumper and all removed parts in the reverse order it was taken off from step 7 to step 1.





**ORIS**  
ACPS

**HELPLINE**



[www.oris-automotive.com/en/acps-automotive-aftermarket-worldwide](http://www.oris-automotive.com/en/acps-automotive-aftermarket-worldwide)

**ORIS**  
ACPS